

# Annual Report

/2020\



**Clearwater – Potlatch  
Timber Protective Association, Inc.**

Protecting Idaho's Timber Since 1905

# Report of the Chief Fire Warden

## OFFICERS AND MEMBERS OF THE CLEARWATER-POTLATCH TIMBER PROTECTIVE ASSOCIATION, INC.

I am pleased to present the annual report for January 1, 2020 to December 31, 2020. This report includes the fiscal yearend period July 1, 2019 to June 30, 2020, providing information of the Association's revenues and expenses.

The Association had two employees retire in 2019 and one in 2020. Assistant Shop Foreman/Equipment Operator Scott Bonnalie with 12 years of service, Equipment Operator/Faller Mike Duffy with 9 years of service and HQ Deputy Warden Mike West with 18 years of service with the Association. I would like to thank them for their dedication and efforts while employed at C-PTPA. The Association hired Headquarters Assistant Fire Warden Dillon Alexander who recently graduated with a fire science degree from the University of Idaho following Mike West's retirement.

The Association faced a worldwide pandemic starting in March 2020 named COVID-19. This pandemic stalled the world economy with quarantines shutting down many places unless you were considered essential. Our organization made a plan after the mandatory quarantine in Idaho was lifted and followed it through the end of the calendar year. We had many challenges regarding contact tracing exposure, acquiring supplies, splitting schedules, figuring out the procedures that other agencies required if we assisted them during suppression efforts and the list goes on. The pandemic did have an effect on the Association's budget with a holdback of 5% (the amount General Fund reduced was \$31,338.00). During the summer, if Idaho's economy was not recovering there would be additional holdbacks of General Fund that we would have to be prepared to return protection dollars in FY 2021. On the bright side, if the economy recovers in Idaho then the 5% may be returned in FY 2022. We only experienced 2 COVID-19 cases among a staff of 34 employees that is spread out at 4 camps while hosting a large number of fire fighters during a late fire season (IMT hosted fires had very good procedures to keep COVID-19 from becoming a problem). We feel very fortunate that we all were employed and did not have to shut the entire office down during the summer or lay off employees after the reopening in early May.

The Forest Protection Agreement and Fire Hazard and Land Management Agreements between IDL and C-PTPA expired in February 2020 and were extended by the IDL State Forester because of the negotiation differences of what changes are needed in the Statewide Master Agreement between IDL and the Federal Cooperators are not resolved.

The Elk River Camp experienced a loss of a foreman cabin in late May from a fire. The insurance company has been very helpful to get this building back in place with funding from the claim. The Board of Directors suggested that Association employees take part with their skills and talent to help rebuild the cabin except portions that require any professional license such electrical, plumbing and septic. The foundation and floor were installed by December due to delays from the late fire season, acquiring supplies that was short due to COVID-19 and projects that we were obligated to complete during the fall season.

The Headquarters Camp lost a valuable seasonal employee due to an unfortunate vehicle accident on his weekend. The entire Association along with interagency fire partners assisted Headquarters during their time of grieving, resignations and attempting to rehire and train fire fighters in late July through August. They overcame a major hurdle during the summer and were able to maintain a small initial attack force until the end of fire season.

## Report of the Chief Fire Warden (Continued)

The C-PTPA experienced below normal fire occurrences and suppressed 27 fires during 2020. There were 23 human caused fires and 4 lightning caused fires that started to occur in early March through November. The majority of the fires were kept small due to rapid initial attack, except 5 fires that grew large and needed additional assistance. The pandemic during the early part of fire season made it challenging on whether or not we would get any outside assistance should we need help and how to deal with keeping exposure to a minimum by attempting to fight fires with a minimum of suppression forces. The Idaho Department of Lands was granted by the Idaho Legislature to contract additional private engines crews for preposition initial attack and movement throughout the state if certain FPD's needed additional staffing. The IDL had C-PTPA host one engine for the Highway 12 corridor which was an engine based out of Deary, Idaho. The Association hosted a Type 3 IMT for the Whitetail Loop Fire and a Type 2 IMT for the Clover Fire that were disastrous fires losing many homes, outbuildings and vehicles and equipment. The overall safety record was very high with no loss of life or serious injuries compared to other western states during fires that spread rapidly in dry fuels, steep terrain and strong winds. We had many employees provide off district fire assistance outside of the Associations protection area to Montana, Oregon, Arizona and Alaska during the peak of the pandemic.

The hazard management program continues to provide project work for the Association and allowing members to pass hazard management rule requirements. The Association had one employee assist SITPA early in May to help them pile slash with an excavator for about one week. We also, managed to provide heavy equipment contract work on the Nez Perce Tribe, IDL and other customers throughout the season. Pile burning season with a jackpot burn was very successful along with a limited amount of grass seed that helps customers with hazard management and erosion control on road construction or firelines.

The Association provided the local YCC a vehicle due to nationwide shortage in the Forest Service fleet that they would normally be sponsored by. The YCC appreciated the use of Boehls Camp crewcab vehicle to get them through the field season and we were invited to their annual job fair to recruit future fire fighters for the Association. During the September 7<sup>th</sup> wind event, the COE/IDPR dock where Boat 36 was located was damaged and our employee trailered the boat to complete the COE boat patrol contract. The Association also upgraded radio, safety equipment for the 1954 Super Cub. We continue to support the local fire departments with FFP equipment, supplies, tools and IDL coordinated RFC grants each year. The Greer Rural Fire Department acquired an operational FFP ARFF Fire Engine and on loan a FEPP Deuce and a half Jeep Kaiser brush truck from C-PTPA to initial attack wildland and structure fires.

The C-PTPA provides a high level of forest and resource protection to our customers and appreciates all Association employees who made personal sacrifices during the fire season. I would like to thank all Association employees, the forest industry, co-operating agencies, and private landowners for their support during 2020.

Respectfully submitted,



Len H. Young  
Chief Fire Warden  
C-PTPA



# C-PTPA Official Directory

---

## OFFICERS

Rich McMillan, President  
Greg Danly, Vice President  
Len Young, Secretary-Treasurer  
Len Young, Chief Fire Warden  
Kimberly S-Browning, Assistant Secretary-Treasurer

## DIRECTORS

Rich McMillan	PotlatchDeltic Corporation
Mike Reggear	Idaho Forest Group
Eric Besaw	State of Idaho
M. John Larson	M. John Larson Logging
Greg Danly	Empire Lumber Company
Paul Larsen	Small Landowner Representative

## FIRE COMMITTEE

Directors serve as Fire Committee

## LEGISLATIVE COMMITTEE

Eric Besaw, State of Idaho

## AUDIT COMMITTEE

Greg Danly, Chairman  
Board of Directors serve as Committee

The Clearwater Timber Protective Association and the Potlatch Timber Protective Association were separately organized in the early 1900's. In 1966, these two entities merged to form the Clearwater-Potlatch Timber Protective Association, a non-corporate entity. Subsequently, on July 16, 1982, the Association completed filings for incorporation under the Idaho Nonprofit Corporation Act and became the Clearwater-Potlatch Timber Protective Association, Inc.

The Association is controlled by forest landowners belonging to its membership and subject to the provisions of the Idaho Forestry Act. The Association is primarily responsible for the conservation and protection of the forests and forestland within the State of Idaho; specifically, the Palouse, Potlatch and North Fork of the Clearwater River drainages.





## Landowners and Acres Protected

Landowner	Acres Protected
PotlatchDeltic Corporation	428,543
Idaho Department of Lands	267,699
Tri-Pro Forest Products	371
Empire Lumber Company	1,898
Corps of Engineers	29,318
Small Private Landowner	152,984
U. S. Forest Service	96,641
Bureau of Land Management	5,687
Tribal Lands	5,687
<b>Total Member Acres Protected</b>	<b>988,828</b>

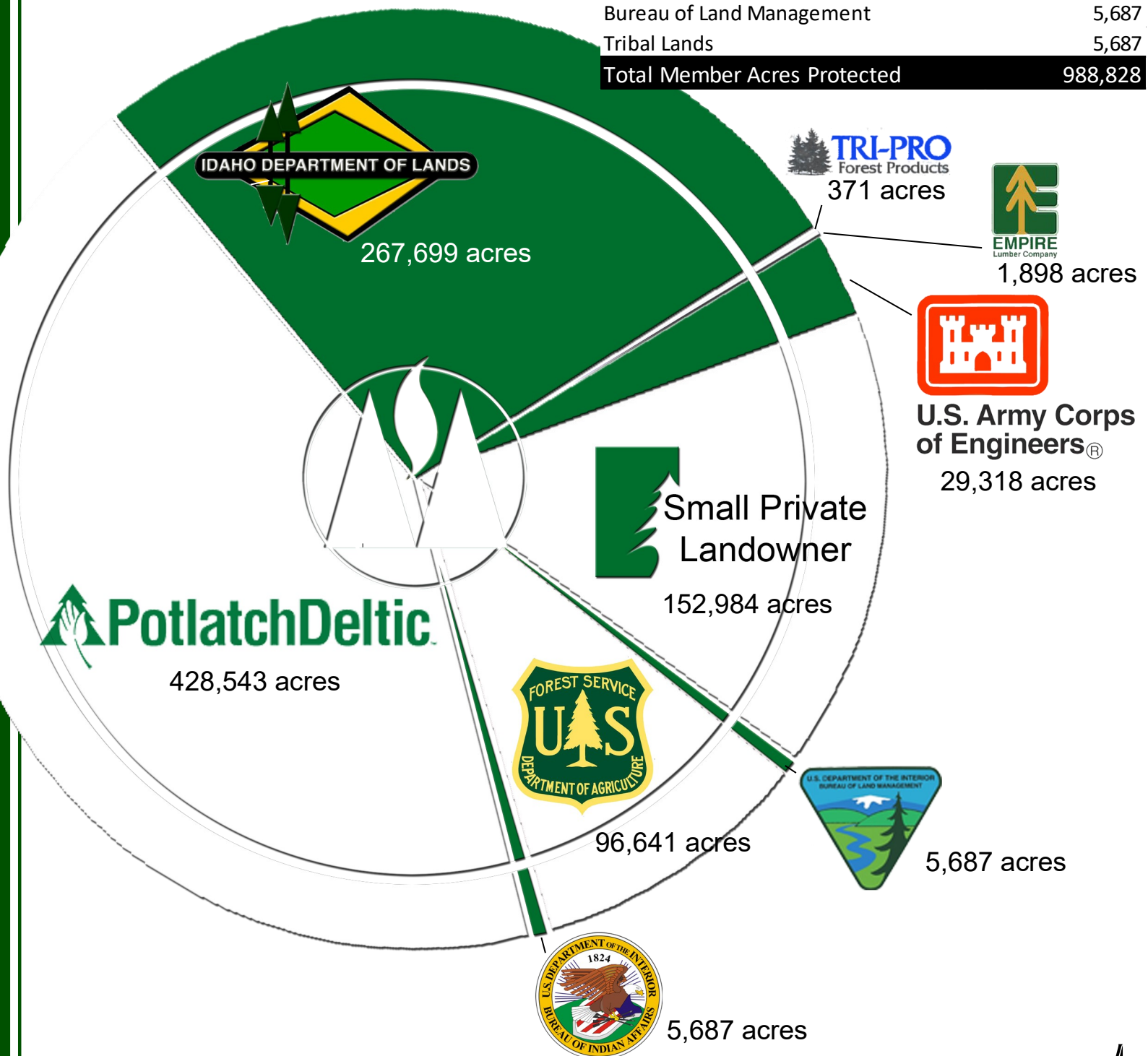





# Mission Statement

---

The mission of the Clearwater-Potlatch Timber Protective Association was a simple premise in 1905 - safely suppress fires when they are small. That mindset has remained for over 116 years and is the idea that still drives the Association today.

An educated firefighter is a safer firefighter. C-PTPA fire crews are trained annually in the basic skills it takes to safely extinguish fires. The Association participates with other agencies to train loggers and rural fire departments to draw from when the need arises. Our efforts do not stop with today's workforce; we target tomorrow's by teaching kids the dangers and uses of fire.

The hazard management program is designed to reduce the fire hazard created by harvesting timber. Prescribed burning provides a relatively controlled method of reducing potential fire growth and provides a suitable environment for tomorrow's trees to grow.

The C-PTPA maintains an administrative complex in Orofino and three satellite fire camps strategically located in our protection area. In an effort to keep unwanted fires as small as possible, four separate facilities are maintained to reduce arrival time on fires.



## Fire Season 2020

The 2020 fire season for the Clearwater-Potlatch Timber Protective Association was characterized as below normal in severity and suppression activity.

The first fire of the season was on March 12th, with the last fire on the 2nd of November. Although the weather remained relatively hot and dry throughout the season, lightning occurrence was below normal, resulting in far fewer fire starts than an average year.

This year, the C-PTPA had 23 human caused fires for 92% of the allowable standard and burned 2,321 acres for 610% of the allowable standard. The human caused fires were equipment use, campfires, other sources, powerlines, debris burning, and miscellaneous.

Lightning Fires	4	Percent Of Total Fires	14.81%
Lightning Acres	0.83	Percent Of Total Acres	0.04%
Person Caused Fires	23	Percent Of Total Fires	85.19%
Person Caused Acres	2,321.09	Percent Of Total Acres	99.96%
Total Fires	27	Average Acres Per Fire	86.00
Total Acres	2,321.92		

Area	Fires	Acres	Total Cost	Cost Per Acre	Cost Per Fire
Boehls	4	113.20	\$210,535.17	\$1,859.85	\$52,633.79
Elk River	4	0.83	\$20,237.99	\$24,383.12	\$5,059.50
Headquarters	6	31.69	\$19,152.84	\$604.38	\$3,192.14
Orofino	13	2,176.20	\$132,912.90	\$61.08	\$10,224.07
Total	27	2,321.92	\$382,838.90	\$164.88	\$14,179.22

The Idaho Department of Lands (IDL) Standard of Protection requires State Districts to meet the following standards:		The Clearwater-Potlatch Timber Protective Association has refined the IDL standards for the fuels and resources of our district to:		C-PTPA 2020
◆	Fires should be contained to less than 10 acres 94% of the time	◆	Fires should be contained to less than 10 acres 97% of the time	5 Fires 15%
◆	IDL should have no more than 34 human caused fires	◆	C-PTPA should have no more than 25 human caused fires	23 Fires 92%
◆	IDL should burn no more than 864 acres	◆	C-PTPA should burn no more than 380 acres	2,321 Acres 610%

### Manning Class For Typical 77 Day Fire Season July 1st Through September 15th

Month	Low	Moderate	High -3	High +3	Very High	Extreme	Total Days
July	0	20	11	0	0	0	31
August	0	12	19	0	0	0	31
September	0	4	11	0	0	0	15
Total	0	36	41	0	0	0	77

## Aircraft



During the 2020 fire season, the Association contracted a Bell 206 L-3 helicopter on 10-minute standby from the Hillcrest Aircraft Company. The exclusive use contract begins July 1st and ends September 27th. This agreement allows the Association the flexibility to get other aircraft from Hillcrest when necessary.

Through a cooperative agreement with the Idaho Department of Lands, two single engine air tankers (SEATS) and two Fire Boss Water Scoopers were available to the Association. The SEATS were used on the Iron Gate and Clover fires. A combination of SEATS and Fire Boss Water Scoopers were used on the Whitetail Loop fire.



Although stationed in Orofino, the helicopter can transport crews from all C-PTPA locations. Air transportation allows for quick initial suppression activities. Once on the scene, the helicopter can attach a water bucket and begin dropping water from a nearby water source. A considerable effort has been made throughout the history of the Association to create and maintain dip ponds inside its protection boundaries. The aircraft is capable of slinging in a 72 gallon water blivet or other cargo to aid firefighters in inaccessible locations. This program, assisted by the retardant

The helicopter was used for a total of 63 hours that included:

- presuppression – 28.3 hours
- fire suppression – 34.7 hours

25,488 gallons of water were dropped at an estimated delivery cost of \$2.50 per gallon.

## Cooperative Agreement

A cooperative agreement continues to this date between the Association and the State Board of Land Commissioners through the Director of the Idaho Department of Lands. The purpose of this agreement is to clarify the forest protection relationship between the Association and the Idaho Department of Lands. It defines the reimbursable emergency fire suppression expenditures that may be incurred by the State and Association. In addition, the agreement addresses the following: (1) fire protection plans, (2) fire management, (3) reports and records, (4) budgets, (5) administrative matters, (6) payments, (7) duration, and (8) limited obligation by the State.



# Dworshak Project - Added Protection

---

The contract with the U.S. Army Corps of Engineers to provide additional protection services on the Dworshak Reservoir was continued for the 2020 fire season. However, the agreement was amended to forgo aerial patrols. The amended agreement provides for a daily boat patrol 5 days a week beginning July 1st and ending September 15th. The boat patrol program has historically proven very effective at detecting abandoned campfires in the many mini-camps along the 52 mile reservoir. The boat is equipped with a high-pressure pump and fire tools should the need arise. In 2020, there were 2 fires on Corps of Engineers property that burned 0.2 acres.

## Hazard Management

---

The Forest Protection Agreement and Fire Hazard and Land Management Agreements between the IDL and C-PTPA expired in 2020. The agreements were extended until 2021 by the State Forester because of negotiation differences in the Statewide Master Agreement between the IDL and Federal Cooperators. Negotiations will continue in 2021.

## Equipment Replacement and Improvements

---

### Inventory Added (DDOD/FEPP):

- None

### Inventory Excessed (FEPP):

None

### Inventory Sold Privately:

- (2) 2014 Ford F350s
- (2) 2019 Ram 3500s
- (1) 2012 Yamaha Grizzly 450
- (1) 2014 Yamaha Viking 700

### Inventory Added (Commercial/Private):

- (2) Can Am Outlander 450 ATVs
- (2) 2019 Ram 3500s





## Acreage and Assessment of Members

7/1/2019 to 6/30/2020

Member	Acreage	\$.60 Assessment
Empire Lumber Company	1,898	\$1,138.80
Tri-Pro Forest Products	371	\$222.60
PotlatchDeltic Corporation	428,543	\$257,125.80
State of Idaho	267,699	\$160,619.40
Federal Agencies	102,328	\$61,396.80
*Corps of Engineers	29,318	\$48,374.70
**Small Private Landowners	141,076	\$161,605.62
1st. Assessment Levied 7/1/2019	971,233	\$690,483.90

\*The Corps of Engineers pays their land assessment directly to the Association based on actual per acre cost.

\*\*Small Private Landowners are assessed \$.60 per acre of timber, plus \$40 per structure. This money is collected by the State of Idaho and remitted to the Association.

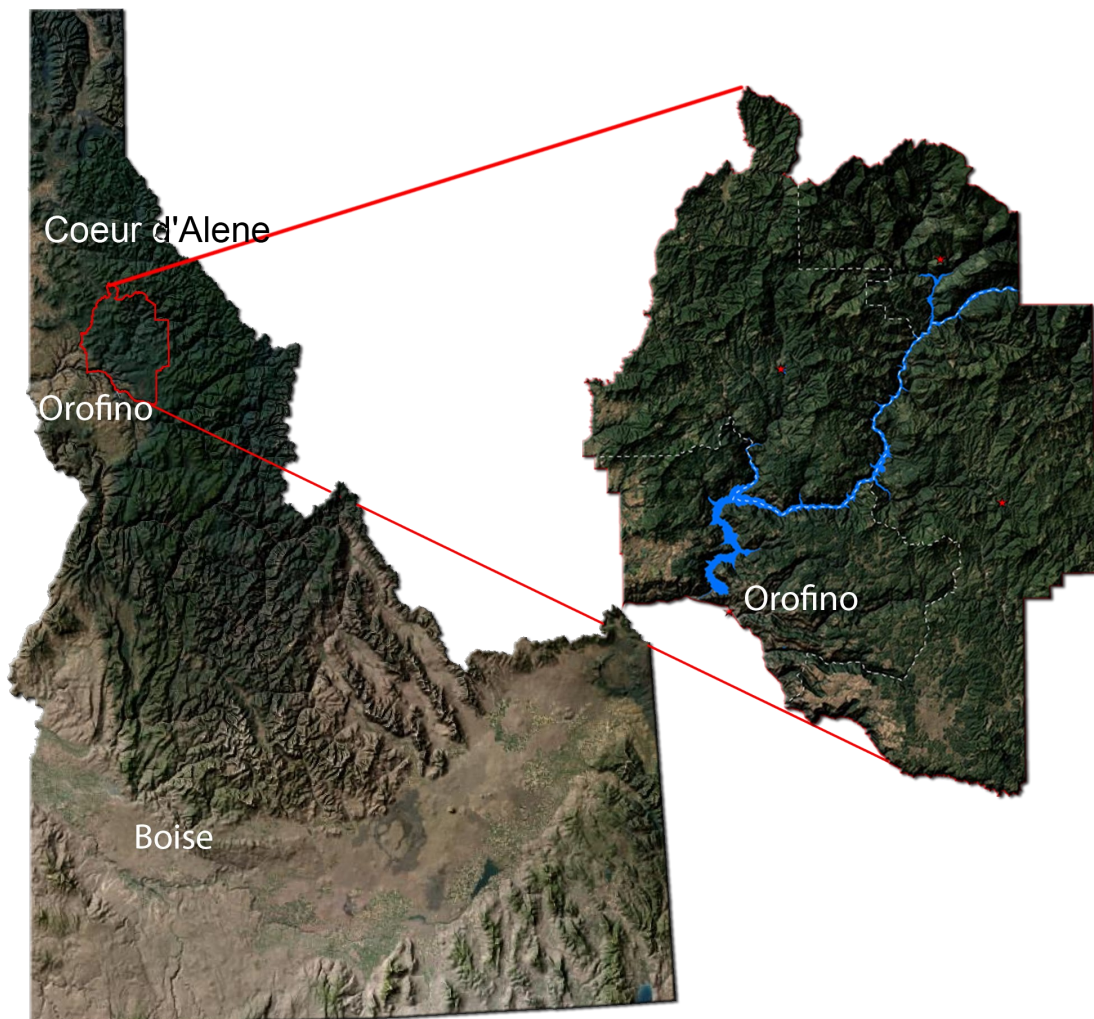



## Balance Sheet - June 30, 2020

### ASSETS

#### Current assets:

Cash and cash equivalents	\$1,145,838
Accounts receivable	\$22,478
Unbilled work in process	\$5,277
Inventory	\$165,701
Prepaid expenses	<u>\$45,153</u>

Total current assets \$1,384,447

#### Property and equipment:

Property and equipment	\$3,684,445
Less accumulated depreciation	<u>(\$2,762,406)</u>

Net property and equipment \$922,039

#### Other assets:

Cash with donor restrictions	\$67,805
------------------------------	----------

Total other assets \$67,805

### TOTAL ASSETS

\$2,374,291

### LIABILITIES

#### Current liabilities:

Accounts payable	\$15,434
Accrued payable	\$36,976
Payroll taxes payable	\$6,354
Accrued vacation	\$54,690
Retiree insurance	\$104,913
Other current liabilities	<u>\$6,253</u>

Total current liabilities \$224,620

Total liabilities \$224,620

#### Net assets:

With donor restrictions	\$67,805
Without donor restrictions	\$2,081,866

Total net assets \$2,149,671

### TOTAL LIABILITIES AND NET ASSETS

\$2,374,291

# 2020 Fires

Date	Fire #	Fire Name	Area	Latitude	Longitude	Acres	Cost	Fuel Model	Landowner	General Cause	Size Class	Value Lost
3/12/2020	99001	Pheasant	ORO	46 27.160	-116 09.110	8	\$ 958.35	Fuel Model 3	Private Land	Debris Burning	.26 - 9.9 acres	\$0.00
4/18/2020	99002	Dark Winter	ORO	46 25.360	-115 58.810	30	\$ 9,780.58	Fuel Model 11	Forest Industry Co.	Equipment Use	10 - 99.9 acres	\$0.00
4/21/2020	99003	Lacey Meadows #1	HQ	46 18.160	-115 51.140	0.1	\$ 1,654.58	Fuel Model 1	Idaho Dept. of Lands	Campfire	0 - .25 acres	\$0.00
4/21/2020	99004	China Gulch	HQ	46 30.760	-115 44.850	31	\$ 4,500.00	Fuel Model 11	Forest Industry Co.	Unknown	10 - 99.9 acres	\$0.00
5/9/2020	99005	Old Peck Grade	ORO	46 29.950	-116 25.330	0.5	\$ 1,269.06	Fuel Model 9	Private Land	Debris Burning	.26 - 9.9 acres	\$0.00
5/27/2020	99006	Twin Ridge	ORO	46 31.300	-116 12.830	0.1	\$ 535.34	Fuel Model 6	Private Land	Miscellaneous	0 - .25 acres	\$0.00
5/31/2020	99007	Water Log	ER	46 41.610	-116 27.350	0.53	\$ 9,274.77	Fuel Model 12	Private Land	Lightning	.26 - 9.9 acres	\$3,500.00
7/6/2020	99008	A Road	ORO	46 30.280	-116 17.830	0.1	\$ 431.22	Fuel Model 11	Corp of Engineers	Debris Burning	0 - .25 acres	\$0.00
7/19/2020	99009	Mclver	ORO	46 34.410	-116 27.160	0.1	\$ 995.85	Fuel Model 12	Private Land	Debris Burning	0 - .25 acres	\$0.00
7/25/2020	99010	Konkolville Mill	ORO	46 28.000	-116 12.140	0.1	\$ 635.59	Fuel Model 12	Private Land	Debris Burning	0 - .25 acres	\$0.00
8/17/2020	99011	Camp 40	BC	46 57.160	-116 04.840	0.1	\$ 2,278.96	Fuel Model 2	Forest Industry Co.	Equipment Use	0 - .25 acres	\$0.00
8/20/2020	99012	Grice Ridge	BC	46 56.730	-116 02.060	0.1	\$ 10,208.81	Fuel Model 2	Forest Industry Co.	Lightning	0 - .25 acres	\$0.00
8/20/2020	99013	Diamond 15	ER	46 48.420	-116 03.710	0.1	\$ 2,818.50	Fuel Model 10	Forest Industry Co.	Lightning	0 - .25 acres	\$150.00
8/20/2020	99014	Lovell Saddle	HQ	46 48.940	-115 46.240	0.1	\$ 3,765.56	Fuel Model 8	Private Land	Lightning	0 - .25 acres	\$0.00
8/23/2020	99015	Dent Debris Pile	ER	46 37.490	-116 13.710	0.1	\$ 5,210.62	Fuel Model 11	Corp of Engineers	Debris Burning	0 - .25 acres	\$0.00
8/30/2020	99016	Whitetail Loop	ORO	46 30.750	-116 21.030	499	\$ 70,344.11	Fuel Model 2	Private Land	Miscellaneous	300 - 999.9 acres	\$100,000.00
9/6/2020	99017	Fidler Flats	HQ	46 20.240	-115 57.800	0.29	\$ 8,048.62	Fuel Model 8	Idaho Dept. of Lands	Unknown	.26 - 9.9 acres	\$350.00
9/6/2020	99018	Wedding Party	ORO	46 33.720	-116 10.810	0.1	\$ 3,633.50	Fuel Model 2	Private Land	Unknown	0 - .25 acres	\$0.00
9/7/2020	99019	Ranchette	ORO	46 30.920	-116 12.380	0.1	\$ 1,350.28	Fuel Model 2	Private Land	Miscellaneous	0 - .25 acres	\$0.00
9/7/2020	99020	Clover	ORO	46 30.940	-116 23.330	1631	\$ 40,863.48	Fuel Model 2	Private Land	Miscellaneous	1,000 - 4,999.9 acres	\$750,000.00
9/7/2020	99021	Canal Powerline	HQ	46 29.740	-115 46.800	0.1	\$ 835.49	Fuel Model 1	Private Land	Miscellaneous	0 - .25 acres	\$0.00
9/7/2020	99022	Ruby Creek Powerline	ER	46 48.440	-116 20.490	0.1	\$ 2,934.10	Fuel Model 8	Forest Industry Co.	Miscellaneous	0 - .25 acres	\$200.00
9/9/2020	99023	Iron Gate	BC	46 55.490	-116 07.340	110	\$186,212.92	Fuel Model 13	Forest Industry Co.	Equipment Use	.26 - 9.9 acres	\$2,500.00
9/16/2020	99024	Cedar	BC	46 54.690	-115 49.680	3	\$ 11,834.48	Fuel Model 8	Forest Industry Co.	Campfire	.26 - 9.9 acres	\$7,000.00
9/16/2020	99025	Upper Fords	ORO	46 28.030	-116 12.680	7	\$ 1,819.49	Fuel Model 3	B.I.A.	Equipment Use	100 - 299.9 acres	\$0.00
10/28/2020	99026	Johnson Gulch	HQ	46 31.890	-115 38.000	0.1	\$ 348.59	Fuel Model 8	Forest Industry Co.	Campfire	0 - .25 acres	\$0.00
11/2/2020	99027	Ridgeview	ORO	46 30.220	-116 23.190	0.1	\$ 296.05	Fuel Model 3	Private Land	Debris Burning	0 - .25 acres	\$0.00

Date	Date of Fire
Fire #	Fire Number
Fire Name	Name of Fire
Area	BC - Boehls Cabin ER - Elk River HQ - Headquarters OR - Orofino
Latitude	Latitude
Longitude	Longitude
Acres	Acres Burned
Cost	Fire Suppression Cost
Fuel Model	Type of Fuels Involved

Landowner	Landowner Where Fire Occurred
General Cause	Cause of Fire
Size Class	Size Class
Value Lost	Any Values Lost or Damaged

Clover Fire, September 7, 2020



# Fire Season Information

## Fire Type By Landowner

Landowner	Lightning	Campfire	Debris Burning	Equipment Use	Arson	Misc.	Fireworks	Other
Forest Industry Co.	2	2	0	3	0	1	0	1
IDL	0	1	0	0	0	0	0	1
U.S. Forest Service	0	0	0	0	0	0	0	0
IDOT	0	0	0	0	0	0	0	0
Private	2	0	5	0	0	5	0	1
BIA	0	0	0	1	0	0	0	0
Corps of Engineers	0	0	2	0	0	0	0	0
BLM	0	0	0	0	0	0	0	0
Totals	4	3	7	4	0	6	0	3

## Fire Type By Month

Month	Fireworks	Lightning	Campfire	Debris Burning	Equipment Use	Arson	Misc.	Other
March	0	0	0	1	0	0	0	0
April	0	0	1	0	1	0	0	1
May	0	1	0	1	0	0	1	0
June	0	0	0	0	0	0	0	0
July	0	0	0	3	0	0	0	0
August	0	3	0	1	1	0	1	0
September	0	0	1	0	2	0	4	2
October	0	0	1	0	0	0	0	0
November	0	0	0	1	0	0	0	0
Totals	0	4	3	7	4	0	6	3

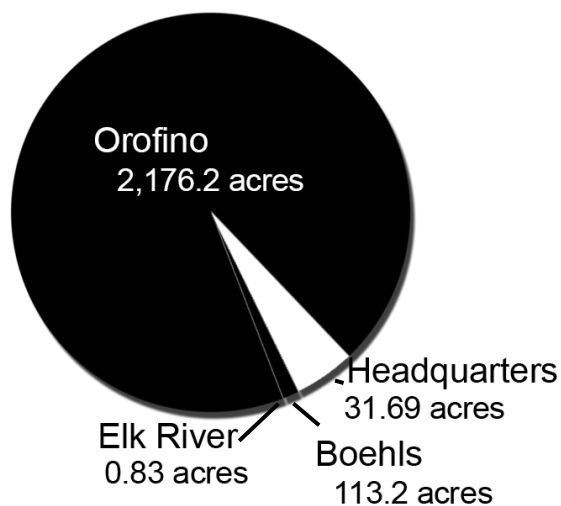

Acres Burned Per Camp

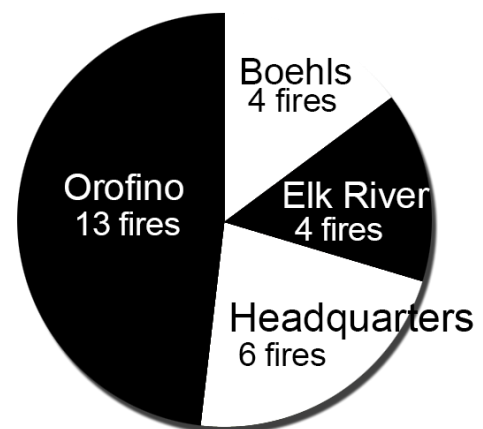

Fires Per Camp

# 40 Year Fire History

Year	Spot		A Fires		B Fires		C Fires		D Fires		E Fires		F Fires		Total Fires	Total Acres
	spot	acres	#	acres	#	acres	#	acres	#	acres	#	acres	#	acres		
1980	42	0.0	0	0.0	2	4.5	0	0.0	1	100.0	0	0.0	0	0.0	45	104.5
1981	55	0.0	4	1.0	4	3.0	1	40.0	0	0.0	0	0.0	0	0.0	64	44.0
1982	55	0.0	3	0.8	5	3.4	0	0.0	1	100.0	0	0.0	0	0.0	64	104.1
1983	52	0.0	0	0.0	5	9.0	1	75.0	0	0.0	0	0.0	0	0.0	58	84.0
1984	151	0.0	0	0.0	17	12.3	2	110.0	0	0.0	1	360.0	0	0.0	171	482.3
1985	79	0.0	7	1.8	9	14.3	2	67.0	0	0.0	0	0.0	0	0.0	97	83.0
1986	172	0.0	0	0.0	43	92.3	10	176.0	2	254.0	1	427.0	1	1,438.0	229	2,387.3
1987	77	0.0	0	0.0	19	21.0	0	0.0	0	0.0	0	0.0	0	0.0	96	21.0
1988	97	0.0	0	0.0	15	28.5	2	64.0	2	228.0	0	0.0	0	0.0	116	320.5
1989	0	0.0	182	0.0	20	32.0	0	0.0	0	0.0	0	0.0	0	0.0	202	32.0
1990	0	0.0	90	4.1	14	24.3	0	0.0	0	0.0	0	0.0	0	0.0	104	28.4
1991	0	0.0	95	10.6	16	23.8	0	0.0	0	0.0	0	0.0	0	0.0	111	34.3
1992	0	0.0	124	13.7	25	38.8	1	50.0	0	0.0	0	0.0	0	0.0	150	102.5
1993	0	0.0	34	3.7	2	2.5	2	40.0	0	0.0	0	0.0	0	0.0	38	46.2
1994	0	0.0	234	30.7	104	185.1	9	144.5	0	0.0	0	0.0	0	0.0	347	360.2
1995	0	0.0	43	6.1	8	13.8	0	0.0	0	0.0	0	0.0	0	0.0	51	19.9
1996	0	0.0	58	8.3	17	20.4	1	20.0	1	230.0	0	0.0	0	0.0	77	278.7
1997	0	0.0	33	3.7	7	14.1	2	51.0	0	0.0	0	0.0	0	0.0	42	68.8
1998	0	0.0	78	8.5	6	12.0	2	46.0	0	0.0	0	0.0	0	0.0	86	66.5
1999	0	0.0	61	8.1	11	20.7	0	0.0	0	0.0	0	0.0	0	0.0	72	28.9
2000	0	0.0	34	4.1	8	15.1	0	0.0	0	0.0	0	0.0	0	0.0	42	19.1
2001	0	0.0	57	7.8	13	17.8	0	0.0	0	0.0	0	0.0	0	0.0	70	25.6
2002	0	0.0	33	4.4	7	13.1	2	41.0	0	0.0	0	0.0	0	0.0	42	58.5
2003	0	0.0	28	3.7	5	7.2	1	31.7	0	0.0	0	0.0	0	0.0	34	42.6
2004	0	0.0	63	7.2	6	12.4	1	19.2	0	0.0	0	0.0	0	0.0	70	38.8
2005	0	0.0	14	2.0	4	21.0	1	26.0	0	0.0	0	0.0	0	0.0	19	49.0
2006	0	0.0	101	14.7	10	15.0	1	34.0	0	0.0	0	0.0	0	0.0	112	63.7
2007	0	0.0	32	4.6	16	38.9	3	76.5	0	0.0	0	0.0	0	0.0	51	120.0
2008	0	0.0	25	3.6	11	13.8	1	90.0	0	0.0	0	0.0	0	0.0	37	107.4
2009	0	0.0	34	3.7	6	5.0	0	0.0	0	0.0	0	0.0	0	0.0	40	8.7
2010	0	0.0	19	2.1	8	17.3	1	23.0	0	0.0	0	0.0	0	0.0	28	42.3
2011	0	0.0	30	4.5	12	17.3	0	0.0	0	0.0	0	0.0	0	0.0	42	21.8
2012	0	0.0	31	3.5	10	23.0	1	80.0	1	310.0	0	0.0	0	0.0	43	416.5
2013	0	0.0	49	6.9	16	23.5	2	102.3	1	110.0	0	0.0	1	1,100.0	69	1,342.7
2014	0	0.0	70	10.7	11	18.8	0	0.0	0	0.0	0	0.0	0	0.0	81	29.5
2015	0	0.0	38	6.6	11	8.0	1	40.0	0	0.0	1	689.0	1	1,750.0	52	2,493.6
2016	0	0.0	28	3.8	4	12.4	1	15.0	0	0.0	0	0.0	0	0.0	33	31.2
2017	0	0.0	17	2.8	4	15.0	0	0.0	0	0.0	0	0.0	0	0.0	21	17.8
2018	0	0.0	28	3.8	13	15.9	2	58.7	0	0.0	0	0.0	0	0.0	43	78.4
2019	0	0.0	31	3.8	5	11.2	2	50.6	0	0.0	0	0.0	0	0.0	38	65.6
2020	0	0.0	16	1.6	6	19.3	2	61.0	1	110.0	1	499.0	1	1,631.0	27	2,321.9
	780	0	1,824	206.5	535	916.3	57	1,632.5	10	1,442.0	4	1,975.0	4	5,919.0	3,214	12,091.3

Size Class Code	Fires			Acres		
	Total	Average/Year	% of Total	Total	Average/Year	% of Total
(S) Spot	780	18.6	24.3%	0.0	0.0	0.0%
(A) .25 or less	1,824	43.4	56.8%	206.5	4.9	1.7%
(B) .26 through 9.9	535	12.7	16.6%	916.3	21.8	7.6%
(C) 10 through 99.9	57	1.4	1.8%	1,632.5	38.9	13.5%
(D) 100 through 299.9	10	0.2	0.3%	1,442.0	34.3	11.9%
(E) 300 through 999.9	4	0.1	0.1%	1,975.0	47.0	16.3%
(F) 1000 through 4999.9	4	0.1	0.1%	5,919.0	140.9	49.0%
<b>Total</b>	<b>3,214</b>	<b>76.5</b>	<b>100.0%</b>	<b>12,091.3</b>	<b>287.9</b>	<b>100%</b>



# 115 Year Fire Occurrence

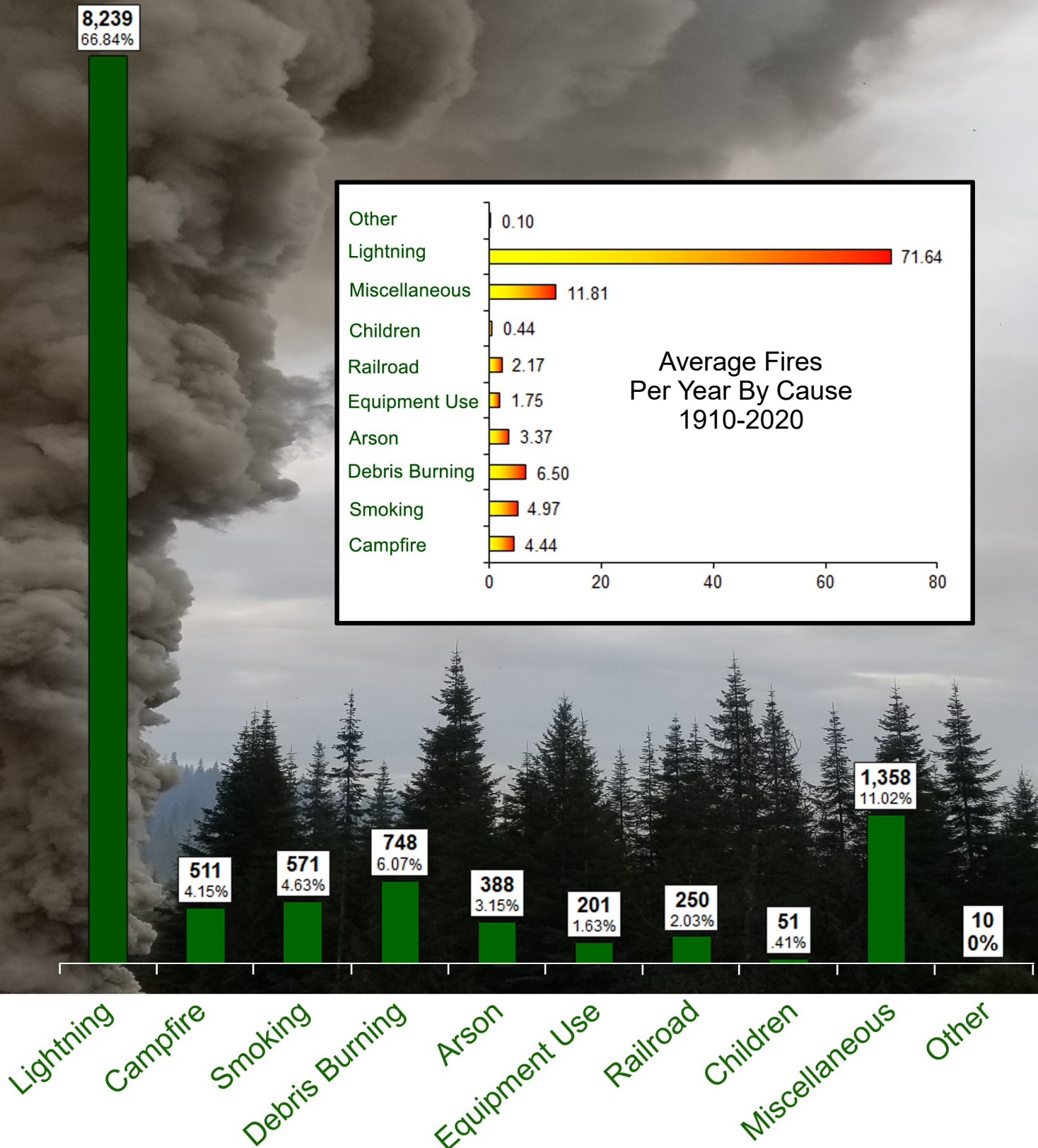
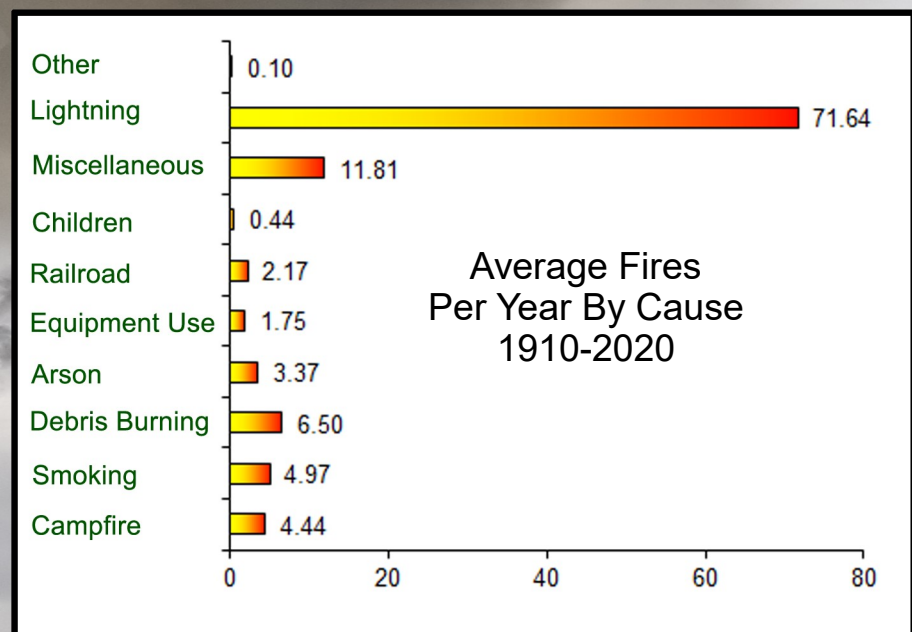



## Airplane Usage on Fires

Program	Cessna 185 (53083)	Super Cub (1679P)	Total
Protection	78.7	4.1	82.8
Corps Of Engineers	0	0	0
Maintenance	1.8	10.2	12
IDL Arson Investigation	0	0	0
Suppression	4.2	0	4.2
Total Hours	84.7	14.3	99.0
% of Total	86%	14%	100%

## Equipment Usage on Fires

Pump Use on Fires		
Type	# of Fires	% of Fires
Pressure Pump	1	4%
Filler Pump	2	7%
Slip Tank	0	0

Equipment Use on Fires		
Type	# of Fires	% of Fires
Type 2	4	15%
Type 4	4	15%
Type 5	1	4%
Type 6	29	107%
Type 7	5	19%
ATV	10	37%
UTV	4	15%
Dozer	7	26%
Excavator	0	0%
Transports	7	26%



# Detection Report

---

To comply with federally mandated ADS-B requirements, a major upgrade was done to the Association owned Piper Super Cub (N1679P) in 2020. All analog components were replaced with digital components, allowing for better aircraft tracking and communication with other aircraft.



Time Reported Until Fire Out	
1-2 Hours	2
2 - 3 Days	5
3 - 5 Days	5
5 - 10 Days	4
10 Days Plus	11
Total	27

Time Reported Until Arrival	
0 - 15 Minutes	1
15 - 30 Minutes	10
30-60 Minutes	8
1 - 1.5 Hours	3
1.5 - 3 Hours	5
Total	27

Fire Detections	Fires	Percent
Agency Lookout	1	4%
Agency Personnel	4	15%
Person Starting Fire	3	11%
Public Report to 911	10	37%
Public Report to Agency	7	26%
Unknown, Other	2	7%
Total	27	100%



# Burn Permits 2020

Type of Burn Permit	Total
Weed control along ditch banks and fence lines	3
Burn Barrel (residential solid waste disposal	111
Crop Residue, Pasture, and CRP burning	119
Hand Piled Logging Slash	31
Machine Piled Logging Slash	5
Residential yard waste/Orchard Clippings	140
2020 Total Burn Permits Issued	409

## Fire Occurrence Comparison

	Lightning	Human Caused
108 Year Average	76.16	37.42
2020 Fire Season	4	23

## Fuel Classifications

### 77 Day Statistical Fire Season July 1 - September 15

Fuel Model	Before	Statistical	After	Season Total
Fuel Model 1 - Short Grass	1	1	0	2
Fuel Model 2 - Timber and Grass	0	6	0	6
Fuel Model 3 - Tall Grass	1	1	1	3
Fuel Model 4 - Chaparral	0	0	0	0
Fuel Model 5 - Brush	0	0	0	0
Fuel Model 6 - Dormant Brush/Hardwood Slash	1	0	0	1
Fuel Model 7 - Southern Rough	0	0	0	0
Fuel Model 8 - Closed Timber Litter	0	4	1	5
Fuel Model 9 - Hardwood/Long Leaf Pine Litter	1	0	0	1
Fuel Model 10 - Timber Litter and Understory	0	1	0	1
Fuel Model 11 - Light Logging Slash	2	2	0	4
Fuel Model 12 - Medium Logging Slash	1	2	0	3
Fuel Model 13 - Heavy Logging Slash	0	1	0	1
Grand Total	7	18	2	27



## Monthly Precipitation Comparison 2020

---

Taken at Elk River, Idaho

	May	June	July	August	September	October
Rainfall (inches)	4.6	3.11	0.49	1.15	1.56	4.61
67 yr average	2.30	2.08	0.81	0.96	1.50	3.56
Departure From Ave.	2.30	1.03	-0.32	0.19	0.06	1.05

Taken at Headquarters, Idaho

	May	June	July	August	September	October
Rainfall (inches)	2.31	1.81	2.51	1.2	2.3	3.41
75 yr average	2.59	2.55	1.18	1.26	1.71	2.56
Departure From Ave.	-0.28	-0.74	1.33	-0.06	0.59	0.85

## Log Production 2020

---

Total log production from operators holding agreement under Surety Bond:	194,690,000.72 BF
Total log production from operators under Holdback Option 2:	6,167,000.52 BF
Total log production from operators under Option 1:	90,000.25 BF
<b>Total:</b>	<b>200,947,001.49 BF</b>

