

Clearwater - Potlatch Timber Protective Association

2015



Annual Report

Report of the Chief Fire Warden

OFFICERS AND MEMBERS OF THE CLEARWATER-POTLATCH TIMBER PROTECTIVE ASSOCIATION, INC.

I am pleased to present the annual report for January 1, 2015 to December 31, 2015. This report includes the fiscal yearend period July 1, 2014 to June 30, 2015, providing information of the Association's revenues and expenses.

The Forest Protection Agreement (contract) was completed and signed by the Association and Idaho Department of Lands after 3 years of difficult negotiations to clarify and agree to terms inserted in the final copy of the document. This contract will be in place for five years with an annual review meeting to see how the Agreement is operating between the parties and if changes will need to be made in the future. The Idaho Department of Lands and C-PTPA Hazard Management Agreement was completed and signed quickly without many discussions regarding the content of the contract (five year contract).

The Oregon Forest Protective Associations and Idaho Protective Associations all met in mid May in Gilchrist, Oregon with the Walker Range Forest Protective Association hosting. The meeting allows the Associations a forum to discuss various topics, such as business operations and challenges faced. The next annual meeting will be hosted by our Association in May, 2016. We look forward to continuing our discussions and building our relationships.

During the 2015 fire season, the Association experienced early initial attack lightning fires. The above normal temperatures and below normal precipitation from spring through the summer played a significant role when a lightning storm on August 10, 2015 passed over the protective boundary starting multiple fires. North and central Idaho, Montana, Washington, Oregon, California and British Columbia, Canada were all overwhelmed with multiple fire ignitions, many of which grew large in a short period of time. The wind event on August 14, 2015 caused two fires being suppressed by C-PTPA to escape extended attack while a new ignition in Orofino made a significant run burning a home down in its path. The Association hosted 3 incident management teams from various parts of the United States and Canada. It was the most expensive suppression cost in Association history. Still, the camps with the help from State employees, Federal employees, private landowners, member employees, Canadian personnel, loggers and contract engines kept persistent initial attack on new starts keeping fires from growing large. Our primary member landowner lost a small amount of acreage of timber due to the persistent initial attack by each camp.

I am proud to be a part of an organization whose employees made personal sacrifices to provide fire protective services for the landowners that we service during this historical fire season. I would like to thank all Association employees, the forest industry, co-operating agencies, and private landowners for their support during 2015.

Respectfully submitted,



Len H. Young
Chief Fire Warden
C-PTPA



Official Directory

OFFICERS

Rich McMillan, President
Greg Danly, Vice President
Len Young, Secretary-Treasurer
Len Young, Chief Fire Warden
Kimberly S-Browning, Asst. Secretary-Treasurer

DIRECTORS

Rich McMillan	Potlatch Corporation
Kyle Wetmore	Idaho Forest Group
Eric Besaw	State of Idaho
Corby Finke	Finke Logging, Inc.
Greg Danly	Empire Lumber Company
Mike Reggear	Small Landowner Representative

FIRE COMMITTEE

Directors serve as Fire Committee

The Clearwater Timber Protective Association and the Potlatch Timber Association were separately organized in the early 1900's. In 1966, these two entities merged to form the Clearwater-Potlatch Timber Protective Association, a non-corporate entity. Subsequently, on July 16, 1982, the Association completed filings for incorporation under the Idaho Nonprofit Corporation Act and became the Clearwater-Potlatch Timber Protective Association, Inc.

The Association is controlled by forest landowners belonging to its membership and subject to the provisions of the Idaho Forestry Act. The Association is primarily responsible for the conservation and protection of the forests and forestland within the State of Idaho; specifically, the Palouse, Potlatch, and North Fork of the Clearwater River drainages.



AUDIT COMMITTEE

Greg Danly, Chairman
Board of Directors serve as Committee

LEGISLATIVE COMMITTEE

Eric Besaw, State of Idaho

Landowners and Acres Protected

Potlatch Corporation

C-O-P-T-P-A

State of Idaho

Tri-Pro Forest Products

Empire Lumber Company

Corps of Engineers

Small Private Landowner

BLM

Tribal Land

U.S. Forest Service

Established 1982
Co-Operative Fire Protection

Landowner	Acres Protected
Potlatch Corporation	428,543
State of Idaho	270,759
Tri-Pro Forest Products	371
Empire Lumber Co.	1,898
Corps of Engineers	29,318
Small Private Landowner	150,395
U. S. Forest Service	96,170
B.L.M. Lands	5,687
Tribal Lands	5,687
Total Member Acres Protected	988,828

Mission Statement

The mission of the Clearwater-Potlatch Timber Protective Association was a simple premise in 1905 - safely suppress fires when they are small. That mindset has remained for over 100 years and is the idea that still drives the Association today.

An educated firefighter is a safer firefighter. C-PTPA fire crews are trained annually in the basic skills it takes to safely extinguish fires. The Association participates with other agencies to train loggers and rural fire departments to draw from when the need arises. Our efforts do not stop with today's workforce; we target tomorrow's by teaching kids the dangers and uses of fire.

The hazard management program is designed to reduce the fire hazard created by harvesting timber. Prescribed burning provides a relatively controlled method of reducing potential fire growth and provides a suitable environment for tomorrow's trees to grow.

The C-PTPA maintains an administrative complex in Orofino and three satellite fire camps strategically located in our protection area. In an effort to keep unwanted fires as small as possible, four separate facilities are maintained to reduce arrival time on fires.

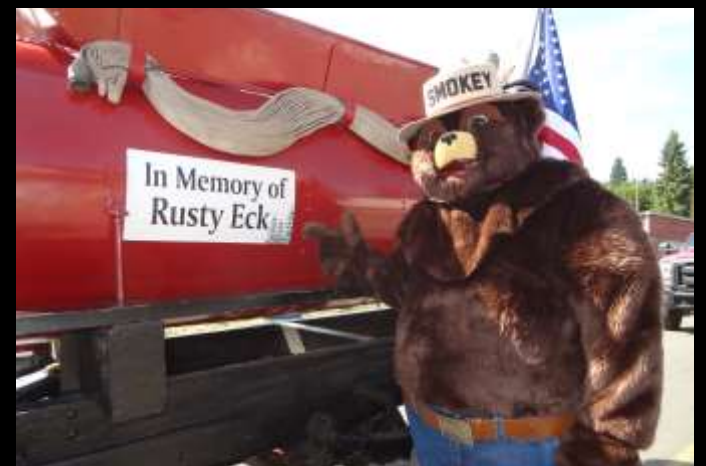

Fire Season 2015

The 2015 fire season for the Clearwater-Potlatch Timber Protective Association was characterized as below normal in severity and suppression activity. Although the Association experienced below average fire starts, three of the fires in August required outside team management, an Association first. Incident Management Teams were brought in to manage the Lolo 2, Last Inch and Municipal fires.

The first fire of the season was on May 23, caused by lightning. A series of afternoon thunderstorms, mostly wet, produced 9 fires during the latter part of May into the first week of June. Between June and the first part of August, the Association experienced 11 fires, 5 of which were human caused. Between August 8th and the 24th, the Association had 30 fires, only one of which was human caused. During this time, the three team managed fires (Lolo 2, Last Inch and Municipal) were all started.

September saw no fire starts. The last two fires of the season were both human caused and occurred on October 12th (Tunnel) and 17th (Larch).

The Idaho Department of Lands Standard of Protection requires State Districts to meet the following standards:	The Clearwater-Potlatch Timber Protective Association has refined the IDL standards for the fuels and resources of our protective district to:	C-PTPA 2015
◆ Fires should be contained to less than 10 acres 94% of the time	◆ Fires should be contained to less than 10 acres 97% of the time	4 Fires 92.3%
◆ IDL should have no more than 34 human caused fires	◆ C-PTPA should have no more than 24 human caused fires	9 Fires 37.5%
◆ IDL should burn no more than 864 acres	◆ C-PTPA should burn no more than 380 acres	2,494 Acres 656.2%

This year, C-PTPA had 9 human caused fires for 37.5% of the allowable standard and burned 2,494 acres for 656.2% of the allowable standard. The human caused fires included debris burns, equipment use and miscellaneous.

Manning Class For Typical 77 Day Fire Season July 1st. Through September 15th

Month	Low	Moderate	High -3	High +3	Very High	Extreme	Total Days
July	2	0	16	1	12	0	31
August	0	0	2	16	13	0	31
September	3	1	9	2	0	0	15
	5	1	27	19	25	0	77

Aircraft

During the 2015 fire season, the Association contracted a Bell 206 L-3 Helicopter on 10-minute standby from Hillcrest Aviation.

Through a cooperative agreement with the Idaho Department of Lands, two single engine air tankers (SEATS) and two Fire Boss Water Scoopers were available to the Association. Neither the SEATS nor the Water Scoopers were used during Association managed fires. Outside air resources were brought in and used for interagency managed fires (Municipal, Lolo 2 and Last Inch).

Although stationed in Orofino, the helicopter can transport crews from all C-PTPA locations. Air transportation allows for quick initial suppression activities. Once on the scene, the helicopter can attach a water bucket and begin dropping water from a nearby water source. The aircraft is capable of slinging in a 72 gallon water blivet or other cargo to aid firefighters in inaccessible locations. This program, assisted by the retardant aircraft, has proven to be an efficient, effective means of wildfire suppression.

The helicopter was used for a total of 102.8 hours that included:

- presuppression – 19.5 hours
- fire suppression – 83.3 hours

Water drops amounted to 36,034 gallons for a delivered cost per gallon of \$4.07. The helicopter was contracted for 110 hours of guaranteed flight time during the 89 day availability period.

An addendum was added in 2014 that that allowed the Association the flexibility to get other aircraft directly from the vendor, outside of normal dispatch channels. For 2015, 15.2 hours were flown under this provision on multiple fires.



Cooperative Agreement

A cooperative agreement continues to this date between the Association and the State Board of Land Commissioners through the Director of the Idaho Department of Lands. The purpose of this agreement is to clarify the forest protection relationship between the Association and the Idaho Department of Lands. It defines the reimbursable emergency fire suppression expenditures that may be incurred by the State and Association. In addition, the agreement addresses the following: (1) fire protection plans, (2) fire management, (3) reports and records, (4) budgets, (5) administrative matters, (6) payments, (7) duration, and (8) limited obligation by the State.

Dworshak Project - Added Protection

The contract with the Corps of Engineers to provide additional protection services was continued for the 2015 fire season. This agreement provides for a daily boat patrol and an aerial patrol of the reservoir on Friday through Monday afternoons, July 1st through September 15th. The boat patrols have proven very effective at detecting abandoned camp fires in the many mini-camps along the reservoir.

In 2015, there was one quarter acre fire on Corps of Engineers property. The marine patrol continued prevention and detection efforts in 2015 and early evening aerial patrols were continued on high activity days and holidays.

Hazard Management

The operating agreement between the State of Idaho and the Clearwater-Potlatch Timber Protective Association for the management of fire hazards resulting from commercial harvest was continued in 2015.

Equipment Replacement and Improvements

During the calendar year 2015, the Association continued excessing older, federally owned equipment in favor of Department of Defense (DDOD) equipment.

Inventory Added: (DDOD)

- (3) Terex Forklifts
- (1) Hyster Forklift
- (1) 1994 Marmon Tractor Truck
- (1) 2.5 Ton Military Tractor

Inventory Excessed (FEPP):

- (1) Case Backhoe
- (2) 2.5 Ton Military Truck
- (1) Caterpillar D7
- (1) Clark Forklift
- (1) Marc Waste Oil Trailer
- (1) 1988 Chevrolet Crew Cab
- (1) 1985 Dodge Crew Cab

Inventory Added (Commercial/Private):

- (1) 2015 Ford Crew Cab
- (1) 2014 Yamaha Viking UTV
- (1) 1999 Caterpillar Backhoe
- (1) 1998 48' Flatbed Trailer

Inventory Sold Privately:

- (1) 1990 GMC Crew Cab
- (1) 2001 Dodge 2500

Acreage and Assessment of Members

7/1/2014 to 6/30/2015

<u>MEMBER</u>	<u>ACREAGE</u>	<u>60 CENT ASSESSMENT</u>
Empire Lumber Company	1,898	\$1,139
Tri-Pro Forest Products	371	\$223
Potlatch Corporation	428,543	\$257,126
State of Idaho	270,327	\$162,196
*Corps of Engineers	29,318	\$46,528
1ST ASSESSMENT LEVIED 7/1/13	<u>730,457</u>	<u>\$467,212</u>

*COE pays their land assessment directly to the Association based on actual per acre cost.

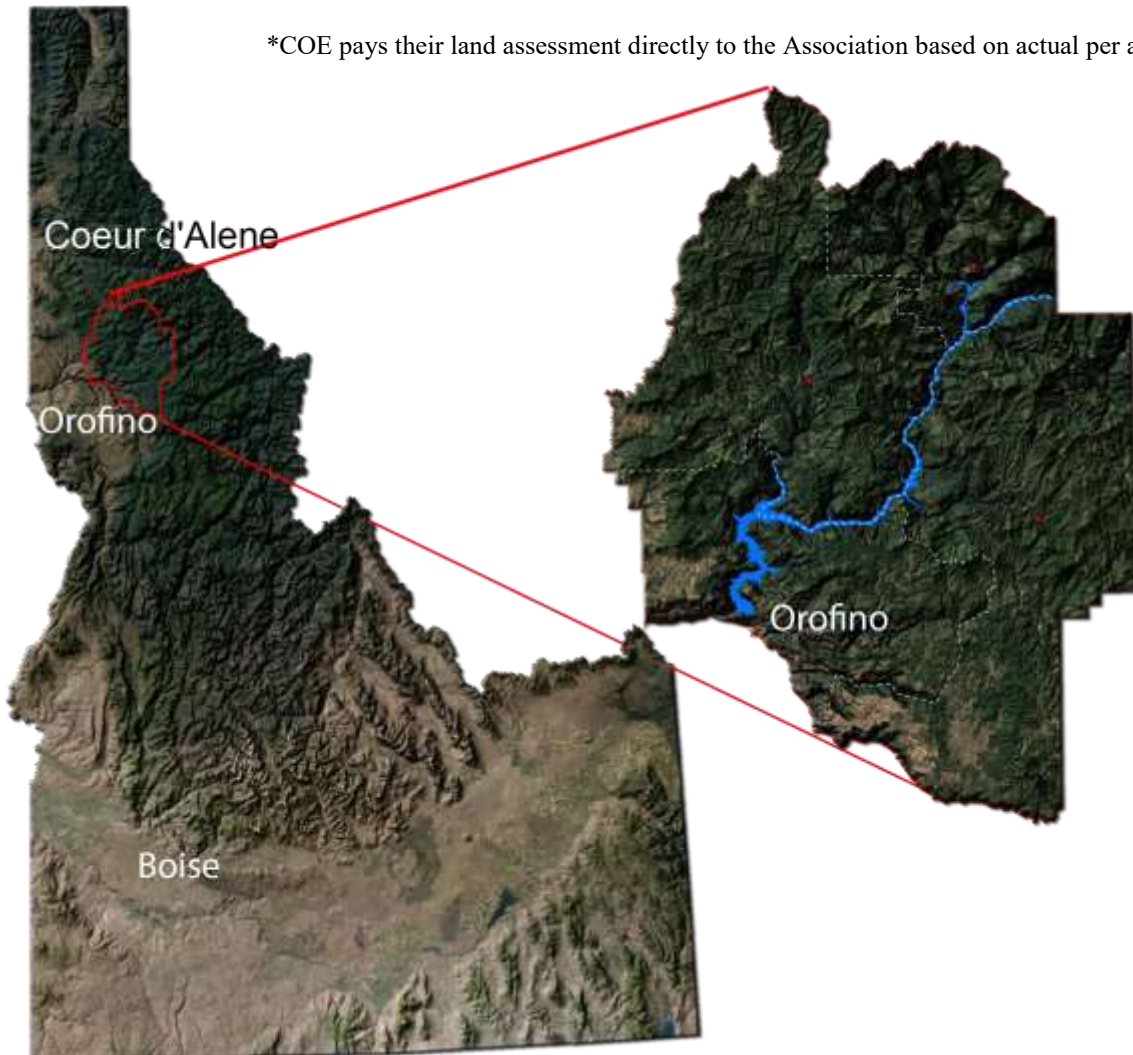

Balance Sheet - June 30, 2015

Assets

Current Assets

Cash	\$966,237
Receivables	\$71,791
Unbilled work in process	\$62,141
Inventory	\$40,387
Prepaid expenses	\$51,545
Total current assets	\$1,192,101

Property and Equipment, net of accumulated depreciation of \$2,070,952	\$988,916
--	-----------

Total Assets	\$2,181,017
--------------	-------------

Liabilities and Net Assets

Current Liabilities

Accounts payable	\$167,392
Accrued interest payable	-
Accrued wages	-
Accrued vacation	\$65,865
Accrued retiree insurance	\$40,772
Deferred revenue	\$2,198
Note payable, current portion	
Total current liabilities	\$276,227

Long-Term Liabilities

Net Pension Liability	\$294,000
Total long term liabilities	\$294,000

Total liabilities	\$570,227
-------------------	-----------

Net Assets

Unrestricted	\$1,572,572
Temporarily restricted	\$38,218

Total net assets	\$1,610,790
------------------	-------------

Total liabilities and net assets	\$2,181,017
----------------------------------	-------------

2015 Fires

Date	Fire #	Fire Name	Area	Latitude	Longitude	Acres	Cost	Fuel Model	Landowner	Cause	Size Class
5/23/2015	99001	Lewis Lip	HQ	46 41.973	115 58.343	0.21	\$2,797.77	Medium Slash	IDL	Lightning	0 - .25 acres
5/23/2015	99002	River View Point	HQ	46 42.452	115 59.967	0.1	\$5,264.52	Closed Canopy Fir	IDL	Lightning	0 - .25 acres
5/24/2015	99003	Best Swamp	ORO	46 34.440	116 08.151	0.1	\$2,699.78	Closed Canopy Fir	IDL	Lightning	0 - .25 acres
5/27/2015	99004	Scramble	BC	46 53.643	115 53.587	0.1	\$2,534.98	Light Slash	IDL	Lightning	0 - .25 acres
6/1/2015	99005	Cedar Pit	ER	46 40.826	116 11.468	0.1	\$601.44	Low Brush and Forbes	PC	Lightning	0 - .25 acres
6/1/2015	99006	Elk Creek Elbow	ER	46 41.394	116 13.144	0.1	\$1,232.31	Pine With a Needle Understory	USFS	Lightning	0 - .25 acres
6/1/2015	99007	Spike Camp	BC	46 54.709	115 51.343	0.1	\$1,200.82	Closed Canopy Fir	PC	Lightning	0 - .25 acres
6/1/2015	99008	Elk Sixty	ORO	46 39.533	116 14.483	0.1	\$2,199.95	Medium Slash	IDL	Lightning	0 - .25 acres
6/3/2015	99009	Woesner Ridge	BC	46 57.717	115 57.765	0.1	\$6,392.23	Natural Heavy Downed and Dead	USFS	Lightning	0 - .25 acres
6/13/2015	99010	Park Lane	HQ	46 22.529	115 59.156	0.1	\$504.98	Annual Grass and Forbes	IDL	Debris Burning	0 - .25 acres
6/15/2015	99011	Homestead Creek	BC	46 51.067	115 54.591	0.25	\$9,012.87	Closed Canopy Fir	COE	Lightning	0 - .25 acres
7/2/2015	99012	Solid Rock	HQ	46 26.986	115 55.310	0.25	\$2,905.36	Pine With a Needle Understory	PVT	Miscellaneous	0 - .25 acres
7/2/2015	99013	Merry Creek	ER	47 04.510	116 12.700	0.25	\$10,869.53	Medium Slash	PC	Equipment Use	0 - .25 acres
7/13/2015	99014	Little Timber Creek	BC	46 58.361	115 53.857	0.1	\$1,258.20	Closed Canopy Fir	IDL	Lightning	0 - .25 acres
7/14/2015	99015	Lost Kitten	ER	46 52.263	116 12.608	0.25	\$4,633.00	Natural Heavy Downed and Dead	PC	Lightning	0 - .25 acres
7/15/2015	99016	Bennett Meadows	ORO	46 28.676	115 57.449	0.25	\$11,277.34	Light Slash	PC	Lightning	.26 - 9.9 acres
7/17/2015	99017	Bone Ridge	ER	46 53.450	115 59.450	0.3	\$12,509.65	Long Needle Pine with Grass Understory	IDL	Lightning	.26 - 9.9 acres
7/18/2015	99018	Bull Run	ER	46 44.212	116 12.126	1	\$4,155.59	Medium Slash	PC	Miscellaneous	.26 - 9.9 acres
7/21/2015	99019	Puddy Tat	HQ	46 46.413	115 53.018	0.25	\$7,760.09	Heavy Slash	PC	Equipment Use	0 - .25 acres
7/26/2015	99020	Knob Point	HQ	42 25.812	115 46.735	0.1	\$7,837.47	Long Needle Pine with Grass Understory	IDL	Lightning	0 - .25 acres
8/8/2015	99021	Woesner Ridge Rock Pit	BC	46 58.178	115 59.152	0.1	\$9,728.52	Natural Heavy Downed and Dead	USFS	Lightning	0 - .25 acres
8/10/2015	99022	West Fork	BC	47 00.669	115 57.861	0.1	\$21,184.70	Natural Heavy Downed and Dead	USFS	Lightning	0 - .25 acres
8/10/2015	99023	Winters Creek	ORO	46 25.464	115 57.083	0.5	\$17,103.21	Heavy Slash	PC	Lightning	.26 - 9.9 acres
8/10/2015	99024	Lolo 2	HQ	46 17.431	115 57.468	1	\$75,994.73	Light Slash	IDL	Lightning	0 - .25 acres
8/10/2015	99025	Battles	HQ	46 26.448	115 53.688	0.1	\$1,608.85	Light Slash	PVT	Lightning	0 - .25 acres
8/10/2015	99026	Pete and Charlie	HQ	46 17.324	115 49.272	0.1	\$3,010.24	Medium Slash	IDL	Lightning	0 - .25 acres
8/11/2015	99027	Rhodes Creek	HQ	46 29.173	115 46.550	0.25	\$985.42	Closed Canopy Fir	PC	Lightning	0 - .25 acres
8/11/2015	99028	Otter Creek	HQ	46 40.741	115 40.822	1	\$1,084.65	Closed Canopy Fir	PC	Lightning	.26 - 9.9 acres
8/11/2015	99029	Casey	HQ	46 40.716	115 53.298	0.1	\$5,476.10	Closed Canopy Fir	IDL	Lightning	0 - .25 acres
8/11/2015	99030	Flume Creek	HQ	46 44.784	115 47.367	0.1	\$1,568.82	Closed Canopy Fir	PC	Lightning	0 - .25 acres
8/11/2015	99031	Head of Bertha	HQ	46 46.516	115 46.252	0.26	\$17,101.37	Closed Canopy Fir	IDL	Lightning	.26 - 9.9 acres
8/10/2015	99032	Elk Butte Face	ER	46 49.800	116 07.240	0.5	\$15,110.64	Natural Heavy Downed and Dead	USFS	Lightning	0 - .25 acres
8/12/2015	99033	West Garden	ER	46 48.770	116 04.220	0.2	\$4,441.76	Closed Canopy Fir	PC	Lightning	0 - .25 acres
8/12/2015	99034	Last Inch	BC	46 59.004	115 59.769	689	\$473,273.35	Natural Heavy Downed and Dead	USFS	Lightning	300 - 999.9 acres
8/12/2015	99035	Lower Bertha	HQ	46 45.849	115 46.561	0.5	\$5,630.84	Closed Canopy Fir	IDL	Lightning	.26 - 9.9 acres
8/11/2015	99036	Corduroy Landing	BC	45 56.838	115 51.031	0.1	\$2,224.81	Closed Canopy Fir	PC	Lightning	0 - .25 acres
8/12/2015	99037	Elk Butte 2 Face	ER	46 50.083	116 07.578	0.1	\$8,587.51	Natural Heavy Downed and Dead	USFS	Lightning	0 - .25 acres
8/11/2015	99038	French Mountain	HQ	46 31.666	115 42.088	0.25	\$7,874.01	Closed Canopy Fir	USFS	Lightning	0 - .25 acres
8/12/2015	99039	Musselman	HQ	46 44.686	115 48.357	0.1	\$357.16	Light Slash	PC	Lightning	0 - .25 acres
8/12/2015	99040	IDL Bertha	HQ	46 45.602	115 46.791	1.5	\$8,062.77	Closed Canopy Fir	IDL	Lightning	.26 - 9.9 acres
8/13/2015	99041	Camp 40	BC	46 57.983	116 03.956	0.1	\$6,910.06	Closed Canopy Fir	PC	Lightning	0 - .25 acres
8/13/2015	99042	Partridge Family	ER	46 47.077	116 08.209	0.1	\$4,353.10	Natural Heavy Downed and Dead	USFS	Lightning	0 - .25 acres
8/13/2015	99043	IDL Bertha 2	HQ	46 45.649	115 46.799	0.1	\$5,876.59	Closed Canopy Fir	IDL	Lightning	0 - .25 acres
8/12/2015	99044	Benton A Road	HQ	46 48.597	115 47.223	0.1	\$699.53	Closed Canopy Fir	PC	Lightning	0 - .25 acres
8/14/2015	99045	Municipal	ORO	46 28.953	116 13.485	1750	\$76,440.63	Closed Canopy Fir	PVT	Miscellaneous	1,000 - 4,999.9 acres
8/12/2015	99046	Freezeout	BC	46 59.414	116 00.412	0.25	\$1,104.67	Natural Heavy Downed and Dead	USFS	Lightning	0 - .25 acres
8/16/2015	99047	Peterson Corner North	HQ	46 24.291	115 47.652	1.5	\$15,851.17	Closed Canopy Fir	PC	Lightning	.26 - 9.9 acres
8/18/2015	99048	Upper Butte	HQ	46 48.495	115 44.669	0.7	\$15,360.20	Closed Canopy Fir	PC	Lightning	.26 - 9.9 acres
8/21/2015	99049	Harvey Ridge	ORO	46 32.365	115 55.881	0.5	\$8,189.22	Closed Canopy Fir	PC	Lightning	.26 - 9.9 acres
8/24/2015	99050	Cookoo	ORO	46 28.459	116 10.520	0.1	\$909.08	Annual Grass and Forbes	PVT	Miscellaneous	0 - .25 acres
10/12/2015	99051	Tunnel	ORO	46 28.159	116 14.473	0.15	\$2,437.18	Pine With a Needle Understory	Railroad	Miscellaneous	0 - .25 acres
10/17/2015	99052	Larch	ORO	46 39.787	116 27.298	40	\$60,363.02	Long Needle Pine with Grass Understory	PVT	Debris Burning	10 - 99.9 acres

Date	Date of Fire
Fire Number	Fire Number
Fire Name	Name of Fire
Area	BC - Boehls Cabin
	ER - Elk River
	HQ - Headquarters
	ORO - Orofino
Lat	Latitude
Long	Longitude
Acres	Acres Burned
Cost	Fire Suppression Cost
Fuel Model	Type of Fuels Involved

Landowner	Landowner
	PC - Potlatch
	IDL - Idaho Dept. of Lands
	COE - Corps of Engineers
	DOT - Dept. of Trans
	IF & G - Idaho Fish and Game
	BIA - Bureau Of Indian Affairs
	USFS - U.S. Forest Service
	BLM - Bureau of Land Management
	PVT—Private Landowner
Cause	Cause of Fire
Size Class	Size Class

Fire Season Information

Fire Type By Landowner

Landowner	Lightning	Campfire	Debris Burning	Equipment Use	Powerline	Misc.	Fireworks
Potlatch	16	0	0	2	0	1	0
Idaho Department of Lands	15	0	1	0	0	0	0
U.S. Forest Service	10	0	0	0	0	0	0
Railroad	0	0	0	0	0	1	0
Private	1	0	1	0	0	3	0
Corps of Engineers	1	0	0	0	0	0	0
Totals	43	0	2	2	0	5	0

Fire Type By Month

Month	Fireworks	Lightning	Campfire	Debris Burning	Equipment Use	Powerline	Misc.
April	0	0	0	0	0	0	0
May	0	4	0	0	0	0	0
June	0	6	0	1	0	0	0
July	0	5	0	0	2	0	2
August	0	28	0	0	0	0	2
September	0	0	0	0	0	0	0
October	0	0	0	1	0	0	1
Totals	0	43	0	2	2	0	5

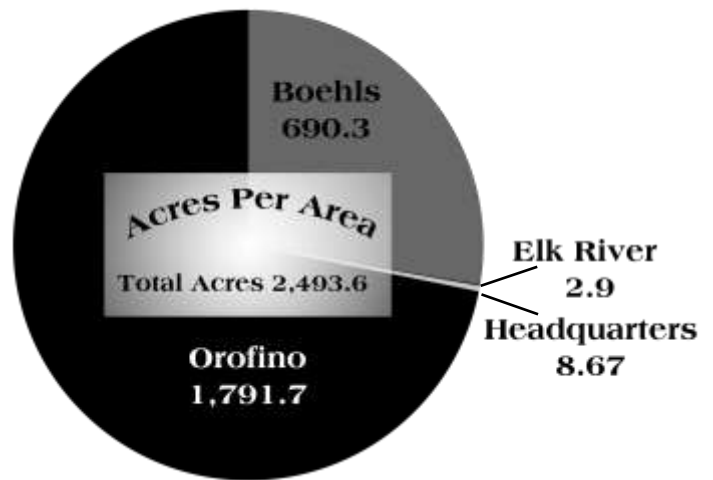
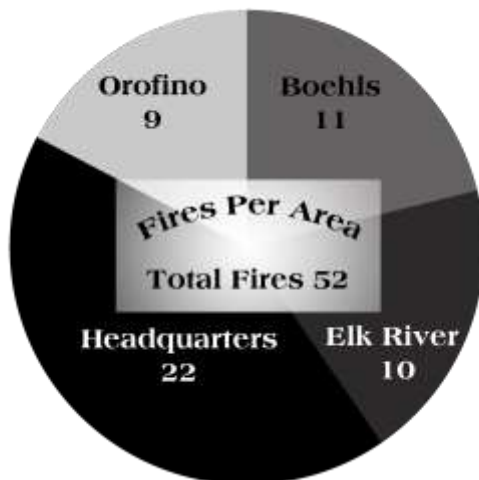

42 Year Fire History

Year	Spot		A Fires		B Fires		C Fires		D Fires		E Fires		F Fires		Total Fires	Total Acres
	spot	acres	#	acres	#	acres	#	acres	#	acres	#	acres	#	acres		
1974	120	0.0	4	1.0	14	11.3	3	83.0	0	0.0	0	0.0	1	1,150.0	142	1,245.3
1975	87	0.0	1	0.3	10	13.4	1	15.0	0	0.0	0	0.0	0	0.0	99	28.6
1976	107	0.0	3	0.8	5	16.0	0	0.0	1	100.0	0	0.0	0	0.0	116	116.8
1977	118	0.0	3	0.8	8	11.4	1	20.0	0	0.0	0	0.0	0	0.0	130	32.2
1978	99	0.0	0	0.0	5	10.0	1	20.0	0	0.0	0	0.0	0	0.0	105	30.0
1979	139	0.0	0	0.0	18	19.8	0	0.0	0	0.0	0	0.0	0	0.0	157	19.8
1980	42	0.0	0	0.0	2	4.5	0	0.0	1	100.0	0	0.0	0	0.0	45	104.5
1981	55	0.0	4	1.0	4	3.0	1	40.0	0	0.0	0	0.0	0	0.0	64	44.0
1982	55	0.0	3	0.8	5	3.4	0	0.0	1	100.0	0	0.0	0	0.0	64	104.1
1983	52	0.0	0	0.0	5	9.0	1	75.0	0	0.0	0	0.0	0	0.0	58	84.0
1984	151	0.0	0	0.0	17	12.3	2	110.0	0	0.0	1	360.0	0	0.0	171	482.3
1985	79	0.0	7	1.8	9	14.3	2	67.0	0	0.0	0	0.0	0	0.0	97	83.0
1986	172	0.0	0	0.0	43	92.3	10	176.0	2	254.0	1	427.0	1	1,438.0	229	2,387.3
1987	77	0.0	0	0.0	19	21.0	0	0.0	0	0.0	0	0.0	0	0.0	96	21.0
1988	97	0.0	0	0.0	15	28.5	2	64.0	2	228.0	0	0.0	0	0.0	116	320.5
1989	0	0.0	182	0.0	20	32.0	0	0.0	0	0.0	0	0.0	0	0.0	202	32.0
1990	0	0.0	90	4.1	14	24.3	0	0.0	0	0.0	0	0.0	0	0.0	104	28.4
1991	0	0.0	95	10.6	16	23.8	0	0.0	0	0.0	0	0.0	0	0.0	111	34.3
1992	0	0.0	124	13.7	25	38.8	1	50.0	0	0.0	0	0.0	0	0.0	150	102.5
1993	0	0.0	34	3.7	2	2.5	2	40.0	0	0.0	0	0.0	0	0.0	38	46.2
1994	0	0.0	234	30.7	104	185.1	9	144.5	0	0.0	0	0.0	0	0.0	347	360.2
1995	0	0.0	43	6.1	8	13.8	0	0.0	0	0.0	0	0.0	0	0.0	51	19.9
1996	0	0.0	58	8.3	17	20.4	1	20.0	1	230.0	0	0.0	0	0.0	77	278.7
1997	0	0.0	33	3.7	7	14.1	2	51.0	0	0.0	0	0.0	0	0.0	42	68.8
1998	0	0.0	78	8.5	6	12.0	2	46.0	0	0.0	0	0.0	0	0.0	86	66.5
1999	0	0.0	61	8.1	11	20.7	0	0.0	0	0.0	0	0.0	0	0.0	72	28.9
2000	0	0.0	34	4.1	8	15.1	0	0.0	0	0.0	0	0.0	0	0.0	42	19.1
2001	0	0.0	57	7.8	13	17.8	0	0.0	0	0.0	0	0.0	0	0.0	70	25.6
2002	0	0.0	33	4.4	7	13.1	2	41.0	0	0.0	0	0.0	0	0.0	42	58.5
2003	0	0.0	28	3.7	5	7.2	1	31.7	0	0.0	0	0.0	0	0.0	34	42.6
2004	0	0.0	63	7.2	6	12.4	1	19.2	0	0.0	0	0.0	0	0.0	70	38.8
2005	0	0.0	14	2.0	4	21.0	1	26.0	0	0.0	0	0.0	0	0.0	19	49.0
2006	0	0.0	101	14.7	10	15.0	1	34.0	0	0.0	0	0.0	0	0.0	112	63.7
2007	0	0.0	32	4.6	16	38.9	3	76.5	0	0.0	0	0.0	0	0.0	51	120.0
2008	0	0.0	25	3.6	11	13.8	1	90.0	0	0.0	0	0.0	0	0.0	37	107.4
2009	0	0.0	34	3.7	6	5.0	0	0.0	0	0.0	0	0.0	0	0.0	40	8.7
2010	0	0.0	19	2.1	8	17.3	1	23.0	0	0.0	0	0.0	0	0.0	28	42.3
2011	0	0.0	30	4.5	12	17.3	0	0.0	0	0.0	0	0.0	0	0.0	42	21.8
2012	0	0.0	31	3.5	10	23.0	1	80.0	1	310.0	0	0.0	0	0.0	43	416.5
2013	0	0.0	49	6.9	16	23.5	2	102.3	1	110.0	1	1,100.0	0	0.0	69	1,342.7
2014	0	0.0	70	10.3	11	18.8	0	0.0	0	0.0	0	0.0	0	0.0	81	29.1
2015	0	0.0	38	6.6	11	8.0	1	40.0	0	0.0	1	689.0	1	1,750.0	52	2,493.6
	1,450	0.0	1,715	193.0	563	924.4	56	1,585.2	10	1,432.0	4	2,576.0	3	4,338.0	3,801	11,048.6

Size Class Code	Fires			Acres		
	Total	Average/Year	% of Total	Total	Average/Year	% of Total
(S) Spot	1,450	34.5	38.7%	0.0	0.0	0.0%
(A) .25 or less	1,715	40.8	45.7%	193.0	4.6	1.9%
(B) .26 through 9.9	563	13.4	15.0%	924.4	22.0	9.0%
(C) 10 through 99.9	56	1.3	1.5%	1,585.2	37.7	15.4%
(D) 100 through 299.9	10	0.2	0.3%	1,432.0	34.1	13.9%
(E) 300 through 999.9	3	0.1	0.1%	1,887.0	44.9	18.3%
(F) 1000 through 4999.9	3	0.1	0.1%	3,277.0	78.0	31.8%
Total	3,750	89.3	100.0%	10,305.0	245.4	100%

105 Year Fire Occurrence

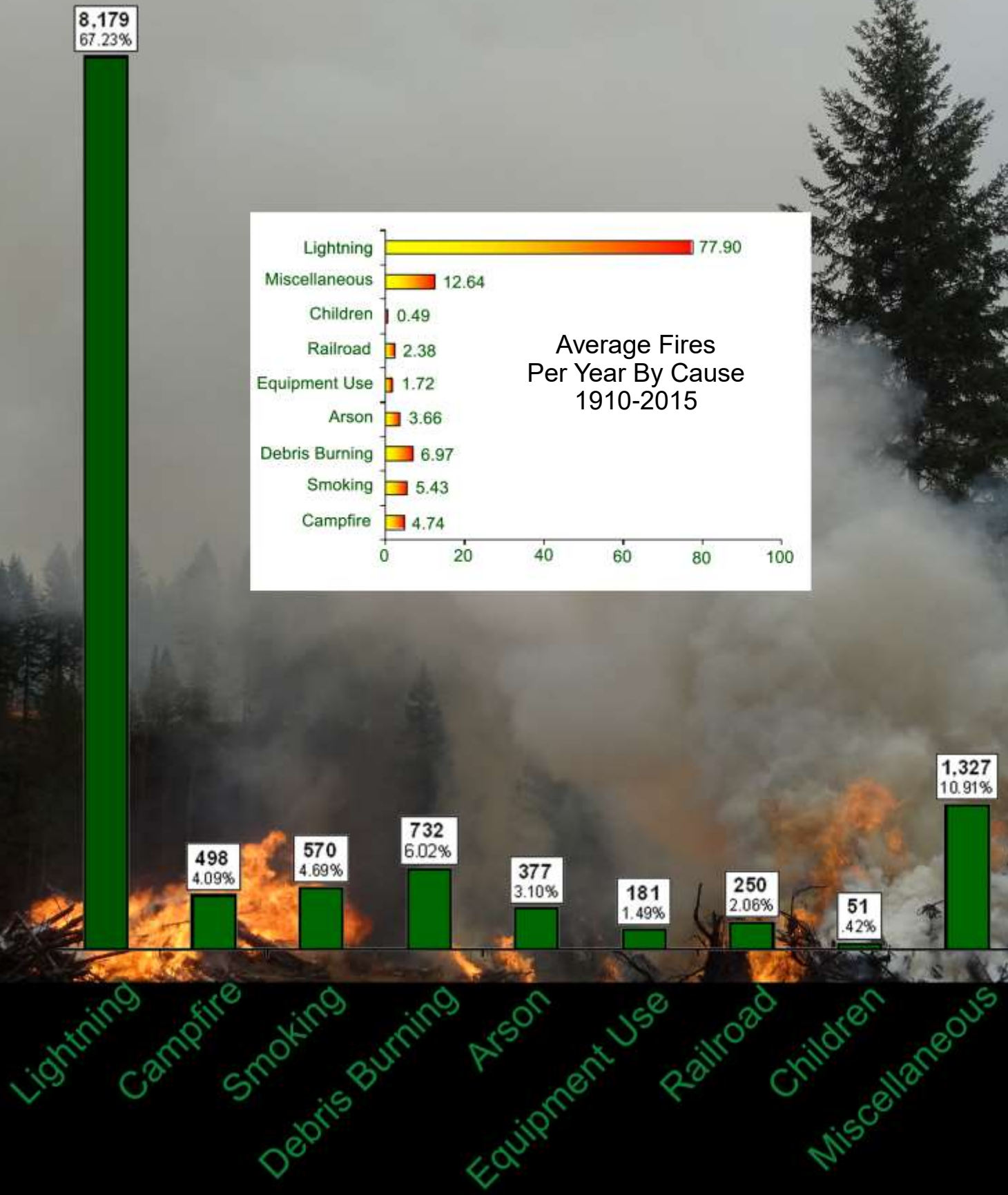

Airplane Usage on Fires

Program	Cessna 185 (53083)	Super Cub (1679P)	Total
Protection	254.9	0	254.9
Corp Of Engineers	0	30.1	30.1
Maintenance	4.3	10.2	14.5
Miscellaneous Jobs	1.3	0	1.3
Suppression	18.3	1.9	20.2
Total Hours	278.8	42.2	321
% of Total	87%	13%	100%

Equipment Usage on Fires

Pump Use on Fires		
Type	# of Fires	% of Fires
Pressure Pump	9	17%
Filler Pump	24	46%
Slip Tank	4	8%

Equipment Use on Fires		
Type	# of Fires	% of Fires
Type 2	5	10%
Type 4	29	56%
Type 6	19	37%
Type 7	17	33%
ATV	14	27%
UTV	10	19%
Dozer	11	21%
Excavator	5	10%



Detection Report 2015

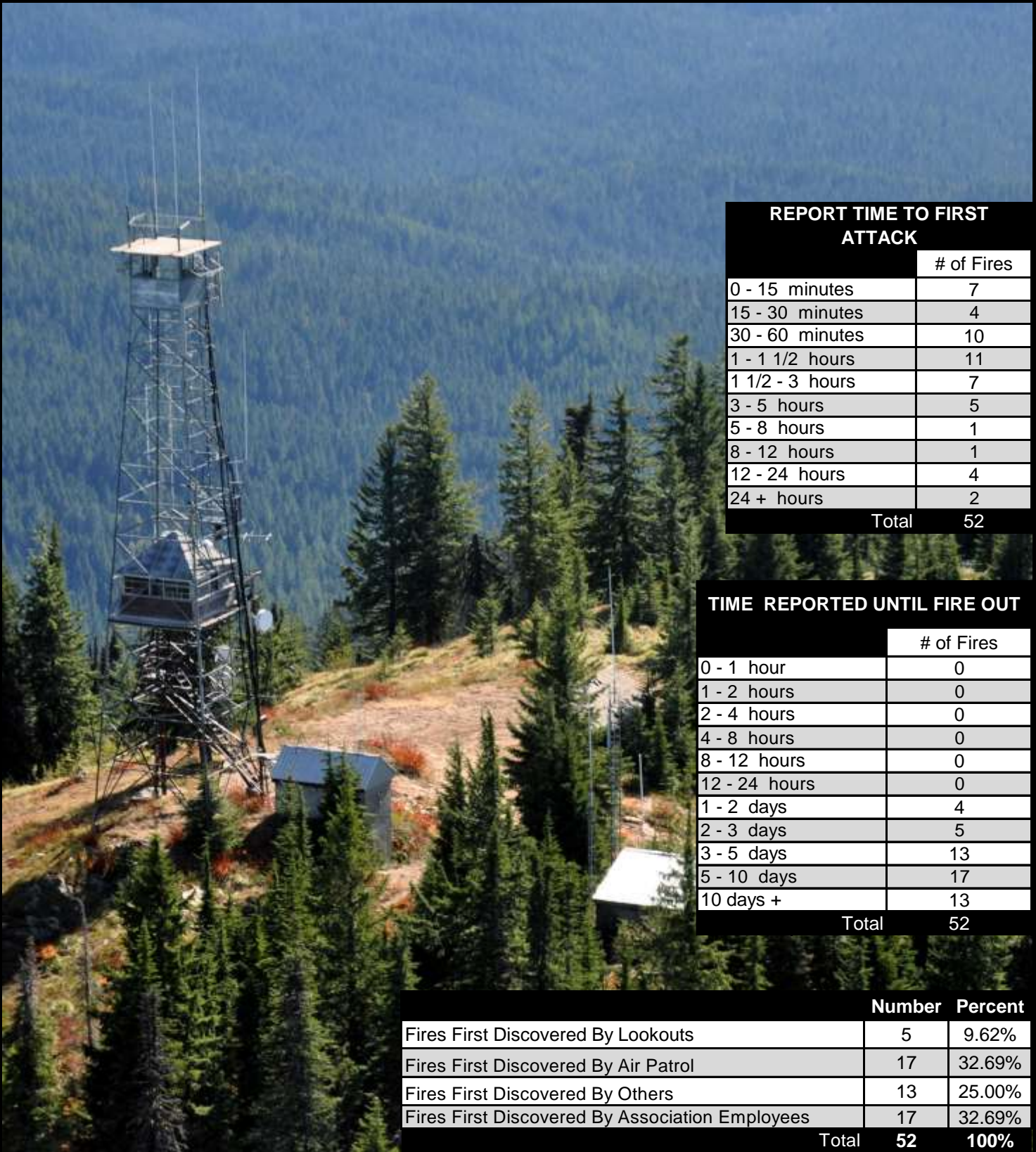

REPORT TIME TO FIRST ATTACK	
	# of Fires
0 - 15 minutes	7
15 - 30 minutes	4
30 - 60 minutes	10
1 - 1 1/2 hours	11
1 1/2 - 3 hours	7
3 - 5 hours	5
5 - 8 hours	1
8 - 12 hours	1
12 - 24 hours	4
24 + hours	2
Total	52

TIME REPORTED UNTIL FIRE OUT	
	# of Fires
0 - 1 hour	0
1 - 2 hours	0
2 - 4 hours	0
4 - 8 hours	0
8 - 12 hours	0
12 - 24 hours	0
1 - 2 days	4
2 - 3 days	5
3 - 5 days	13
5 - 10 days	17
10 days +	13
Total	52

	Number	Percent
Fires First Discovered By Lookouts	5	9.62%
Fires First Discovered By Air Patrol	17	32.69%
Fires First Discovered By Others	13	25.00%
Fires First Discovered By Association Employees	17	32.69%
Total	52	100%

Fuel Classifications

77 Day Statistical Fire Season
July 1 - September 15

Fuel Model	Before	Statistical	After	Season Total
(A) Annual Grasslands & Forbs	1	1	0	2
(C) Long Needle Pine with Grass	0	2	1	3
(F) Low Brush and Forbs	1	0	0	1
(G) Natural Heavy Down & Dead	1	8	0	9
(H) Closed Canopy Fir	4	18	0	22
(I) Heavy Slash	0	2	0	2
(J) Medium Slash	2	3	0	5
(K) Light Slash	2	3	0	5
(L) Perennial Grasslands	0	0	0	0
(T) Sagebrush & Grass	0	0	0	0
(U) Pine with Needle Understory	1	1	1	3
Grand Total	12	38	2	52

Fire Occurrence Comparison

	Lightning	Human Caused
105 Year Average	77.94	37.96
2015 Fire Season	43	9

Burning Permits 2015

Type of Burn Permit	Total
Burn Barrel (Residential Solid Waste Disposal)	59
Crop Residue, Pasture, and CRP Burning	69
Machine Piled Logging Slash	22
Residential Yard Waste/Orchard Clippings	82
Weed Control	1
Range Land	1
Special Use	1
2015 Total Burn Permits Issued	235

Monthly Precipitation Comparison 2015

TAKEN AT ELK RIVER, IDAHO

	May	June	July	August	September	October
Rainfall (inches)	1.36	0.04	0.0	Trace	0.0	0.16
62 Year Average	2.54	2.33	0.94	1.10	1.65	3.96
Departure	-1.18	-2.29	-0.94	-1.00	-1.65	-3.80

TAKEN AT HEADQUARTERS, IDAHO

	May	June	July	August	September	October
Rainfall (inches)	2.47	1.09	1.08	0.7	2.3	2.9
70 Year Average	2.85	2.82	1.26	1.40	1.86	2.63
Departure	-0.38	-1.73	-0.18	-0.70	0.44	0.27

Log Production 2015

Total log production from operators holding contracts under Forest Master Contract:	Not Available
State-owned	1,250,580 BF
Total log production from operators holding agreement under Surety Bond:	196,854,314 BF
Total log production from operators under Holdback Option 2:	13,537,671 BF
Total log production from operators under Option 1:	301,707 BF
	211,944,272 BF