

# Clearwater-Potlatch Timber Protective Association



## 2019 Annual Report

# Report of the Chief Fire Warden

---

## OFFICERS AND MEMBERS OF THE CLEARWATER-POTLATCH TIMBER PROTECTIVE ASSOCIATION, INC.

I am pleased to present the annual report for January 1, 2019 to December 31, 2019. This report includes the fiscal yearend period July 1, 2018 to June 30, 2019, providing information of the Association's revenues and expenses.

The Association meeting was hosted by Douglas Forest Protective Association in Roseburg, Oregon. Douglas FPA purchased property to move their entire facility and showed us how it will look in the future and how long it took to save up the money and get all the permits to start building. This will allow them some better access to the interstate and not have to deal with traffic to transport heavy equipment or run engines for fire incidents. The meeting consisted of many challenges. The meeting brought up a lot of good topics that each Association shared to help one another out. C-PTPA will host next year's meeting in Missoula, Montana to change up the venue.

We have completed all Type 6 engine upgrades for every camp with Boehls Camp type 6 engine going into service which started in 2018. The Association owned Cessna 185 had upgrades of electronics and safety tracking devices completed to meet FAA requirements to fly into airports that require ADS-B tracking. We continue to upgrade fleet with capital bank monies to reduce the reliance on FEPP equipment.

C-PTPA suppressed 35 fires during 2019. Suspicious fires started to occur in early March through September. We had one fire that someone put a whole turkey on the site and a fire occurred. The responsible party would not admit to igniting the fire that damaged a half acre of PotlatchDeltic's young regeneration stand near Pierce. Other fires during the season that were considered suspicious in nature; we were not able to locate any responsible party. Majority of the human and lightning caused fires were kept small due to rapid initial attack, using engines, heavy equipment, water tenders and an exclusive use helicopter along with support from Grangeville for additional aircraft on some fires.

We attended an exploding target test sponsored by Idaho Department of Lands, Craigmont FPD that was coordinated by ATF, MTDC, LEO agencies to demonstrate how they can cause fires in forested or vegetated areas verses normal test area with artificially putting natural fuels together in a rock pit. Wildland fire agencies from IDL, USFS, BLM, NPT, C-PTPA and WADNR attended to observe the tests.

Association employees provided cost savings to the base budget going off district to Alaska, California, and New Mexico and supporting Douglas FPA in Oregon on a large fire. The Association assisted Ponderosa with an early season Type 2 fire providing overhead, engine and a water tender in May. Some employees supported the GVC Type 3 Team up in Powell and a Compact request by Oregon Department of Forestry for a vacant Helicopter Manager in Pendleton, Oregon.

The hazard management program continues to help the Association members meet hazard rule requirements and give Association seasonal employees valuable experience installing handlines, pile burning and broadcast burning experience while preparing for any new initial attack fires. We had a few broadcast burns that burned in the spring and fall. The Nez Perce Tribe has been providing hazard management projects, gate fabrication and installation projects, road maintenance projects and equipment repairs and maintenance to trailers and equipment for our shop program. We continue to build this relationship with NPT to help the shop offset costs to operate when some projects from within our protection are on the decline until state timber sales are sold and logged.

The C-PTPA provides a high level of forest and resource protection to our customers and appreciates all Association employees who made personal sacrifices during the fire season. We would like to recognize and thank Scott Bonnalie and Mike Duffy, both of whom retired after many years of dedicated service. I would also like to thank the forest industry, co-operating agencies, and private landowners for their support during 2019.

Respectfully submitted,



Len H. Young  
Chief Fire Warden



# C-PTPA Official Directory

---

## OFFICERS

Rich McMillan, President  
Greg Danly, Vice President  
Len Young, Secretary-Treasurer  
Len Young, Chief Fire Warden  
Kimberly S-Browning, Assistant Secretary-Treasurer

## DIRECTORS

Rich McMillan	PotlatchDeltic Corporation
Mike Reggear	Idaho Forest Group
Eric Besaw	State of Idaho
M. John Larson	M. John Larson Logging
Greg Danly	Empire Lumber Company
Paul Larson	Small Landowner Representative

## FIRE COMMITTEE

Directors serve as Fire Committee

## LEGISLATIVE COMMITTEE

Eric Besaw, State of Idaho

## AUDIT COMMITTEE

Greg Danly, Chairman  
Board of Directors serve as Committee

The Clearwater Timber Protective Association and the Potlatch Timber Protective Association were separately organized in the early 1900's. In 1966, these two entities merged to form the Clearwater-Potlatch Timber Protective Association, a non-corporate entity. Subsequently, on July 16, 1982, the Association completed filings for incorporation under the Idaho Nonprofit Corporation Act and became the Clearwater-Potlatch Timber Protective Association, Inc.

The Association is controlled by forest landowners belonging to its membership and subject to the provisions of the Idaho Forestry Act. The Association is primarily responsible for the conservation and protection of the forests and forestland within the State of Idaho; specifically, the Palouse, Potlatch and North Fork of the Clearwater River drainages.



# Landowners and Acres Protected

Member	Acres Protected
Potlatch Corporation	428,543
State of Idaho – Department of Lands	267,699
Empire Lumber Co.	1,898
Corps of Engineers	29,318
Tri-Pro Forest Products	371
Small Private Landowner	152,984
B.L.M. Lands	5,687
U.S. Forest Service	96,641
Tribal Lands	5,687
<b>Total Member Acres Protected</b>	<b>988,828</b>

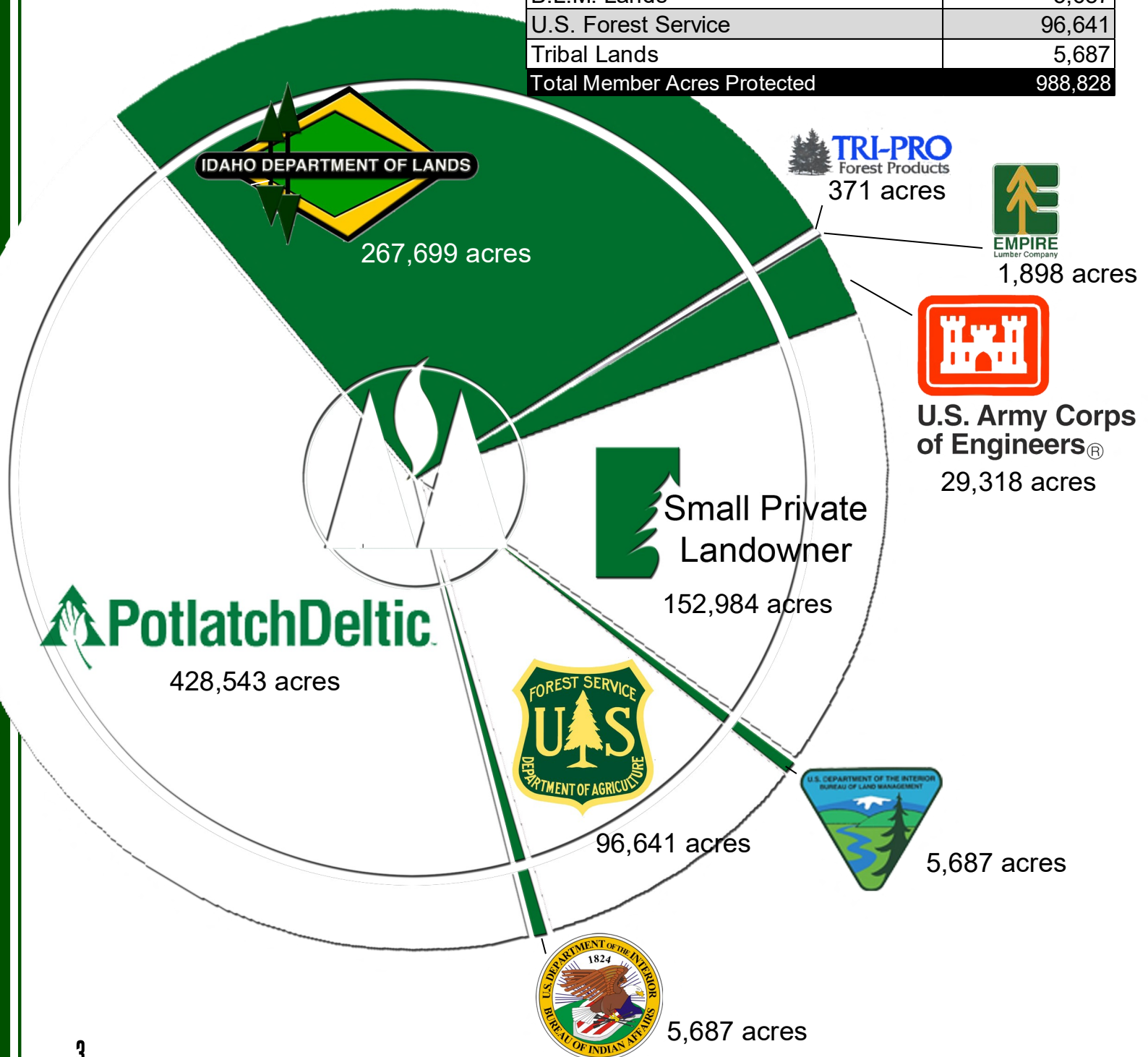



# Mission Statement

The mission of the Clearwater-Potlatch Timber Protective Association was a simple premise in 1905 - safely suppress fires when they are small. That mindset has remained for over 114 years and is the idea that still drives the Association today.



An educated firefighter is a safer firefighter. C-PTPA fire crews are trained annually in the basic skills it takes to safely extinguish fires. The Association participates with other agencies to train loggers and rural fire departments to draw from when the need arises. Our efforts do not stop with today's workforce; we target tomorrow's by teaching kids the dangers and uses of fire.

The hazard management program is designed to reduce the fire hazard created by harvesting timber. Prescribed burning provides a relatively controlled method of reducing potential fire growth and provides a suitable environment for tomorrow's trees to grow.

The C-PTPA maintains an administrative complex in Orofino and three satellite fire camps strategically located in our protection area. In an effort to keep unwanted fires as small as possible, four separate facilities are maintained to reduce arrival time on fires.



# Fire Season 2019

The 2019 fire season for the Clearwater-Potlatch Timber Protective Association was characterized as below normal in severity and suppression activity.

The first fire of the season was on March 14th, with the last fire on the 5th of November. Although the weather remained relatively hot and dry throughout the season, lightning occurrence was below normal, resulting in far fewer fire starts than an average year.

This year, the C-PTPA had 24 human caused fires for 96% of the allowable standard and burned 63.35 acres for 16.67% of the allowable standard. The human caused fires were arson, equipment use, campfires, other sources, powerlines, and miscellaneous.

<b>Lightning Fires</b>	<b>14</b>	<b>Percent Of Total Fires</b>	<b>36.84%</b>
<b>Lightning Acres</b>	<b>2.25</b>	<b>Percent Of Total Acres</b>	<b>3.43%</b>
<b>Person Caused Fires</b>	<b>24</b>	<b>Percent Of Total Fires</b>	<b>63.16%</b>
<b>Person Caused Acres</b>	<b>63.35</b>	<b>Percent Of Total Acres</b>	<b>96.57%</b>
<b>Total Fires</b>	<b>38</b>	<b>Average Acres Per Fire</b>	<b>1.73</b>
<b>Total Acres</b>	<b>65.60</b>		

Area	Fires	Acres	Total Cost	Cost Per Acre	Cost Per Fire	Mutual Aid Responses	False Alarm Responses
Boehls	4	0.95	\$43,790.17	\$46,094.92	\$10,947.54	0	4
Elk River	7	6.25	\$77,527.28	\$12,404.36	\$11,075.33	0	2
Headquarters	17	42.10	\$59,010.78	\$1,401.68	\$3,471.22	2	10
Orofino	10	16.30	\$105,569.90	\$6,476.68	\$10,556.99	10	11
<b>Total</b>	<b>38</b>	<b>65.6</b>	<b>\$285,898.13</b>	<b>\$4,358.20</b>	<b>\$7,523.64</b>	<b>12</b>	<b>27</b>

The Idaho Department of Lands (IDL) Standard of Protection requires State Districts to meet the following standards:		The Clearwater-Potlatch Timber Protective Association has refined the IDL standards for the fuels and resources of our district to:		C-PTPA 2019
◆	Fires should be contained to less than 10 acres 94% of the time	◆	Fires should be contained to less than 10 acres 97% of the time	2 Fires 5%
◆	IDL should have no more than 34 human caused fires	◆	C-PTPA should have no more than 25 human caused fires	24 Fires 96%
◆	IDL should burn no more than 864 acres	◆	C-PTPA should burn no more than 380 acres	63.35 Acres 16.67%

## Manning Class For Typical 77 Day Fire Season July 1st Through September 15th

Month	Low	Moderate	High -3	High +3	Very High	Extreme	Total Days
July	2	1	11	14	3	0	31
August	0	1	3	21	6	0	31
September	1	1	10	3	0	0	15
<b>Total</b>	<b>3</b>	<b>3</b>	<b>24</b>	<b>38</b>	<b>9</b>	<b>0</b>	<b>77</b>



# Aircraft

---



During the 2019 fire season, the Association contracted a Bell 206 L-3 Helicopter on 10-minute standby from Hillcrest Aviation. The exclusive use contract begins July 1st and ends September 27th. This agreement also allowed the Association the flexibility to get other aircraft when necessary.

Through a cooperative agreement with the Idaho Department of Lands, two single engine air tankers (SEATS) and two Fire Boss Water Scoopers were available to the Association. The SEATS were used on the Lower Ford 2 Fire; the Fire Boss Water Scoopers were not used.

Although stationed in Orofino, the helicopter can transport crews from all C-PTPA locations. Air transportation allows for quick initial suppression activities. Once on the scene, the helicopter can attach a water bucket and begin dropping water from a nearby water source. A considerable effort has been made throughout the history of the Association to create and maintain dip ponds inside its protection boundaries. The aircraft is capable of slinging in a 72 gallon water blivet or other cargo to aid firefighters in inaccessible locations. This program, assisted by the retardant aircraft, has proven to be an efficient, effective means of wildfire suppression.

The helicopter was used for a total of 32.4 hours that included:

- presuppression – 10.4 hours
- fire suppression – 22.0 hours

24,400 gallons of water were dropped at an estimated delivery cost of \$1.66 per gallon.

## Cooperative Agreement

---

A cooperative agreement continues to this date between the Association and the State Board of Land Commissioners through the Director of the Idaho Department of Lands. The purpose of this agreement is to clarify the forest protection relationship between the Association and the Idaho Department of Lands. It defines the reimbursable emergency fire suppression expenditures that may be incurred by the State and Association. In addition, the agreement addresses the following: (1) fire protection plans, (2) fire management, (3) reports and records, (4) budgets, (5) administrative matters, (6) payments, (7) duration, and (8) limited obligation by the State.



# Dworshak Project - Added Protection

---

The contract with the U.S. Army Corps of Engineers to provide additional protection services on the Dworshak Reservoir was continued for the 2019 fire season. However, the agreement was amended to forgo aerial patrols. The amended agreement provides for a daily boat patrol 5 days a week beginning July 1st and ending September 15th. The boat patrol program has historically proven very effective at detecting abandoned campfires in the many mini-camps along the 52 mile reservoir. The boat is equipped with a high-pressure pump and fire tools should the need arise. In 2019, there were 2 fires on Corps of Engineers property that burned 4.2 acres.

## Hazard Management

---

The operating agreement between the State of Idaho and the Clearwater-Potlatch Timber Protective Association for the management of fire hazards resulting from commercial harvest was continued in 2019.

## Equipment Replacement and Improvements

---

### Inventory Added (DDOD/FEPP):

- None

### Inventory Excessed (FEPP):

None

### Inventory Sold Privately:

- (1) 2017 Ford F-150

### Inventory Added (Commercial/Private):

- (1) Suzuki 500 Kingquad ATV
- (1) 2003 Ford F-550 Engine
- (1) 2019 Ford F-150
- (1) 2019 Ford F-350
- (1) 2019 Ford F-550
- (4) 2019 Ram 350





# Acreage and Assessment of Members

7/1/2018 to 6/30/2019

Member	Acreage	\$.60 Assessment
Empire Lumber Company	1,898	\$1,138.80
Tri-Pro Forest Products	371	\$222.60
PotlatchDeltic Corporation	428,543	\$257,125.80
State of Idaho	267,699	\$160,619.40
Federal Agencies	102,328	\$61,396.98
*Corps of Engineers	29,318	\$48,374.70
**Small Private Landowners	141,076	\$161,605.62
1st. Assessment Levied 7/1/2018	971,233	\$690,483.90

\*The Corps of Engineers pays their land assessment directly to the Association based on actual per acre cost.

\*\*Small Private Landowners are assessed \$.60 per acre of timber, plus \$40 per structure. This money is collected by the State of Idaho and remitted to the Association

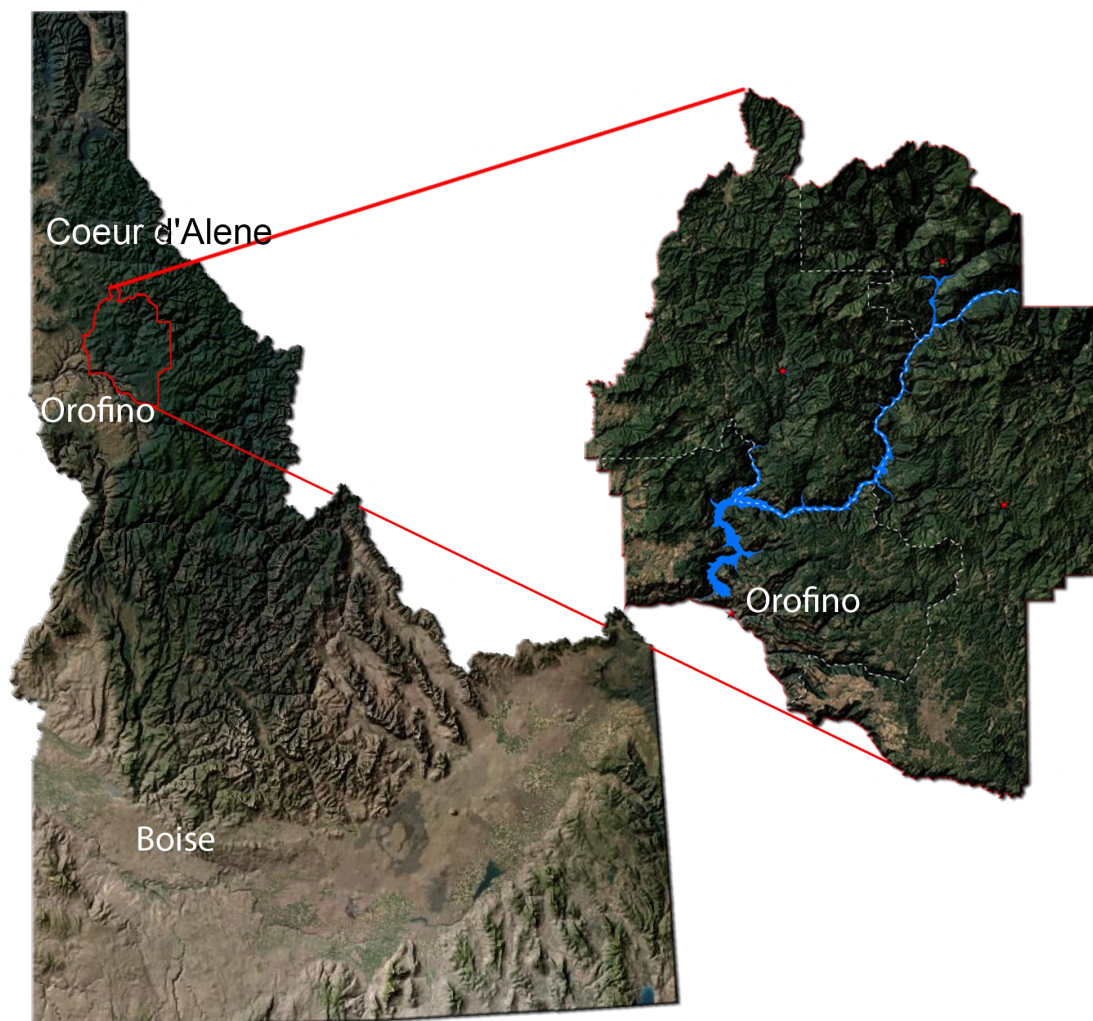

## Balance Sheet - June 30, 2019

---

### Assets

#### Current Assets

Cash	\$1,073,641
Receivables	\$44,140
Unbilled Work in Process	\$119,107
Inventory	\$130,019
Prepaid Expenses	\$37,497
Total Current Assets	\$1,404,404

#### Property and Equipment, Net of Accumulated

Depreciation of \$2,858,572	\$855,373
-----------------------------	-----------

Other Assets: Cash with donor restriction	\$68,530
---	----------

Total Assets	\$2,328,307
--------------	-------------

### Liabilities and Net Assets

#### Current Liabilities

Accounts Payable	\$38,201
Deferred Revenue	\$4,350
Other Current Liabilities	\$205,742

Total Current Liabilities	\$248,293
---------------------------	-----------

#### Net Assets

Unrestricted	\$2,011,484
Temporarily Restricted	\$68,530

Total Net Assets	\$2,080,014
------------------	-------------

Total Liabilities and Net Assets	\$2,328,307
----------------------------------	-------------



# 2019 Fires

Date	Fire #	Fire Name	Area	Latitude	Longitude	Acres	Cost	Fuel Model	Landowner	General Cause	Size Class
3/14/2019	99001	Lower Ford	OR	46 27.610	-116 13.340	0.1	\$ 1,388.31	Fuel Model 2	BIA	Campfire	0 - .25 acres
3/14/2019	99002	Dark Mine	OR	46 27.710	-116 12.980	0.1	\$ 1,741.76	Fuel Model 2	BIA	Campfire	0 - .25 acres
4/21/2019	99003	North Schlader	HQ	46 23.860	-115 54.370	0.1	\$ 1,961.44	Fuel Model 11	IDL	Arson	0 - .25 acres
4/25/2019	99004	Schlader Y	HQ	46 23.520	-115 54.790	0.1	\$ 4,073.63	Fuel Model 1	IDL	Arson	0 - .25 acres
5/16/2019	99005	Cat Spur	ER	46 57.580	-116 14.942	0.1	\$ 1,325.31	Fuel Model 11	Forest Industry Co.	Lightning	0 - .25 acres
6/1/2019	99006	Elk Mountain	HQ	46 47.080	-115 46.570	0.1	\$ 2,643.44	Fuel Model 11	IDL	Lightning	0 - .25 acres
6/17/2019	99007	Purple	BC	46 58.520	-115 52.510	0.1	\$ 2,891.67	Fuel Model 8	Forest Industry Co.	Lightning	0 - .25 acres
6/26/2019	99008	Anderson Power	OR	46 26.120	-116 12.340	0.1	\$ 1,341.43	Fuel Model 1	Private Land	Miscellaneous	0 - .25 acres
6/26/2019	99009	East Bovill Powerline	ER	46 49.650	-116 23.350	0.1	\$ 1,008.84	Fuel Model 1	Private Land	Miscellaneous	0 - .25 acres
6/29/2019	99010	Stony Butte	BC	46 58.110	-116 06.110	0.5	\$ 14,341.30	Fuel Model 10	US Forest Service	Lightning	.26 - 9.9 acres
7/6/2019	99011	Three Meadows	OR	46 35.580	-116 17.960	0.1	\$ 2,991.75	Fuel Model 10	Corp of Engineers	Miscellaneous	0 - .25 acres
7/10/2019	99012	Delaney Saddle	BC	47 02.700	-115 57.620	0.1	\$ 9,506.58	Fuel Model 5	BLM	Lightning	0 - .25 acres
7/13/2019	99013	Silver Butte	HQ	46 42.420	-116 21.070	0.25	\$ 8,022.01	Fuel Model 2	IDL	Lightning	0 - .25 acres
7/18/2019	99014	Chambers Creek	ER	46 42.420	-116 21.070	5.5	\$ 47,115.57	Fuel Model 12	Forest Industry Co.	Equipment Use	.26 - 9.9 acres
7/28/2019	99015	Pierce Overlook	HQ	46 29.370	-115 48 430	0.5	\$ 15,399.82	Fuel Model 11	Forest Industry Co.	Arson	.26 - 9.9 acres
7/28/2019	99016	Lower Ford 2	OR	46 25.220	-116 11.910	10.8	\$ 41,720.37	Fuel Model 3	Private Land	Miscellaneous	10 - 99.9 acres
7/29/2019	99017	Rhodes Creek	HQ	46 28.120	-115 47.640	0.1	\$ 3,003.33	Fuel Model 2	IDL	Unknown	0 - .25 acres
8/1/2019	99018	Peck Moon	OR	46 30.210	-116 26.100	0.6	\$ 5,258.14	Fuel Model 2	Private Land	Miscellaneous	.26 - 9.9 acres
8/8/2019	99019	White Pine	BC	46 56.780	-115 50.630	0.25	\$ 17,050.62	Fuel Model 12	Forest Industry Co.	Equipment Use	0 - .25 acres
8/9/2019	99020	West Anthony	ER	46 57.790	-116 12.250	0.1	\$ 2,774.50	Fuel Model 8	US Forest Service	Lightning	0 - .25 acres
8/11/2019	99021	Boathouse Surprise	ER	46 45.690	-115 59.120	0.1	\$ 6,418.14	Fuel Model 11	Forest Industry Co.	Lightning	0 - .25 acres
8/11/2019	99022	Three Cedars	ER	46 54.150	-116 11.730	0.1	\$ 10,202.55	Fuel Model 10	Forest Industry Co.	Lightning	0 - .25 acres
8/11/2019	99023	Robin	ER	46 53.970	-116 11.940	0.25	\$ 8,682.37	Fuel Model 12	Forest Industry Co.	Lightning	0 - .25 acres
8/24/2019	99024	View Point	OR	46 30.600	-116 18.730	4.1	\$ 40,935.40	Fuel Model 2	Corp of Engineers	Miscellaneous	.26 - 9.9 acres
8/28/2019	99025	Ford 13	OR	46 27.460	-116 01.100	0.1	\$ 8,165.44	Fuel Model 8	Forest Industry Co.	Lightning	0 - .25 acres
8/30/2019	99026	Silver Butte 2	HQ	46 42.690	-115 48.970	0.25	\$ 5,482.46	Fuel Model 2	IDL	Lightning	0 - .25 acres
8/31/2019	99027	Miles Creek	HQ	46 19.520	-115 55.740	0.1	\$ 512.20	Fuel Model 1	IDL	Campfire	0 - .25 acres
9/1/2019	99028	South Reeds	HQ	46 36.330	-115 45.740	0.1	\$ 5,185.47	Fuel Model 10	Forest Industry Co.	Lightning	0 - .25 acres
9/2/2019	99029	North Divide	HQ	46 27.720	-115 50.490	0.1	\$ 2,096.70	Fuel Model 1	IDOT	Unknown	0 - .25 acres
9/2/2019	99030	West Divide	HQ	46 27.410	-115 50.870	0.1	\$ 2,269.87	Fuel Model 1	IDOT	Unknown	0 - .25 acres
9/5/2019	99031	Bottom Divide	HQ	46 27.150	-115 51.210	0.1	\$ 1,311.37	Fuel Model 1	IDOT	Unknown	0 - .25 acres
9/8/2019	99032	North Snake	HQ	46 36.610	-115 53.390	0.1	\$ 500.00	Fuel Model 10	Forest Industry Co.	Lightning	0 - .25 acres
9/15/2019	99033	Deer Cedar Y	OR	46 29.547	-116 07.639	0.1	\$ 500.00	Fuel Model 2	IDL	Campfire	0 - .25 acres
9/29/2019	99034	Borderline	HQ	46 22.110	-115 57.330	0.1	\$ 550.49	Fuel Model 2	IDL	Unknown	0 - .25 acres
10/9/2019	99035	Brown's Ridge	HQ	46 20.710	-115 50.330	0.1	\$ 1,000.00	Fuel Model 10	IDL	Unknown	0 - .25 acres
10/25/2019	99036	Quail Power	OR	46 30.490	-116 20.630	0.2	\$ 1,527.30	Fuel Model 9	Private Land	Miscellaneous	0 - .25 acres
11/1/2019	99037	Third Street	HQ	46 23.540	-115 56.640	39.8	\$ 3,999.87	Fuel Model 2	IDL	Miscellaneous	10 - 99.9 acres
11/5/2019	99038	Lower Brown's Ridge	HQ	46 20.980	-115 51.490	0.1	\$ 998.68	Fuel Model 1	IDL	Unknown	0 - .25 acres

Date	Date of Fire
Fire Number	Fire Number
Fire Name	Name of Fire
Area	BC - Boehls Cabin ER - Elk River HQ - Headquarters OR - Orofino
Latitude	Latitude
Longitude	Longitude
Acres	Acres Burned
Cost	Fire Suppression Cost
Fuel Model	Type of Fuels Involved

Landowner	Landowner
	IDL - Idaho Dept. of Lands COE - Corps of Engineers IDOT - Idaho Dept. of Transportation IF & G - Idaho Fish and Game BIA - Bureau Of Indian Affairs BLM - Bureau of Land Management
General Cause	Cause of Fire
Size Class	Size Class

# Fire Season Information

## Fire Type By Landowner

Landowner	Lightning	Campfire	Debris Burning	Equipment Use	Arson	Misc.	Fireworks	Other
Forest Industry Co.	8	0	0	2	1	0	0	0
IDL	3	2	0	0	2	1	0	4
U.S. Forest Service	2	0	0	0	0	0	0	0
IDOT	0	0	0	0	0	0	0	3
Private	0	0	0	0	0	5	0	0
BIA	0	2	0	0	0	0	0	0
Corps of Engineers	0	0	0	0	0	2	0	0
BLM	1	0	0	0	0	0	0	0
Totals	14	4	0	2	3	8	0	7

## Fire Type By Month

Month	Fireworks	Lightning	Campfire	Debris Burning	Equipment Use	Arson	Misc.	Other
March	0	0	2	0	0	0	0	0
April	0	0	0	0	0	2	0	0
May	0	1	0	0	0	0	0	0
June	0	3	0	0	0	0	2	0
July	0	2	0	0	1	1	2	1
August	0	6	1	0	1	0	2	0
September	0	2	1	0	0	0	0	4
October	0	0	0	0	0	0	1	1
November	0	0	0	0	0	0	1	1
Totals	0	14	4	0	2	3	8	7

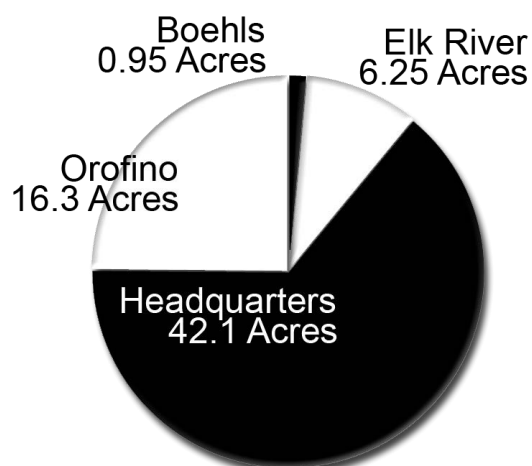

Acres Burned Per Camp

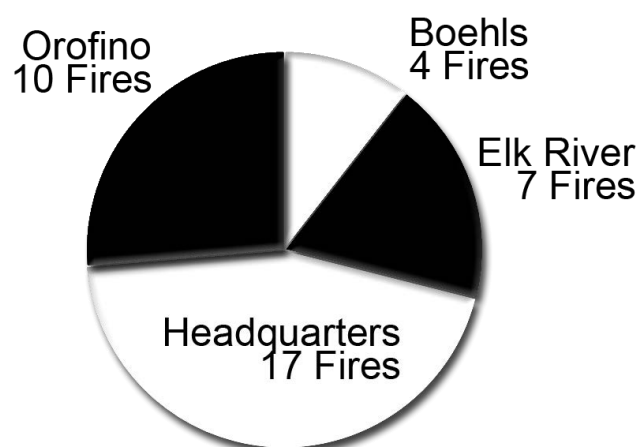

Fires Per Camp



# 40 Year Fire History

Year	Spot		A Fires		B Fires		C Fires		D Fires		E Fires		F Fires		Total Fires	Total Acres
	spot	acres	#	acres	#	acres	#	acres	#	acres	#	acres	#	acres		
1979	139	0.0	0	0.0	18	19.8	0	0.0	0	0.0	0	0.0	0	0.0	157	19.8
1980	42	0.0	0	0.0	2	4.5	0	0.0	1	100.0	0	0.0	0	0.0	45	104.5
1981	55	0.0	4	1.0	4	3.0	1	40.0	0	0.0	0	0.0	0	0.0	64	44.0
1982	55	0.0	3	0.8	5	3.4	0	0.0	1	100.0	0	0.0	0	0.0	64	104.1
1983	52	0.0	0	0.0	5	9.0	1	75.0	0	0.0	0	0.0	0	0.0	58	84.0
1984	151	0.0	0	0.0	17	12.3	2	110.0	0	0.0	1	360.0	0	0.0	171	482.3
1985	79	0.0	7	1.8	9	14.3	2	67.0	0	0.0	0	0.0	0	0.0	97	83.0
1986	172	0.0	0	0.0	43	92.3	10	176.0	2	254.0	1	427.0	1	1,438.0	229	2,387.3
1987	77	0.0	0	0.0	19	21.0	0	0.0	0	0.0	0	0.0	0	0.0	96	21.0
1988	97	0.0	0	0.0	15	28.5	2	64.0	2	228.0	0	0.0	0	0.0	116	320.5
1989	0	0.0	182	0.0	20	32.0	0	0.0	0	0.0	0	0.0	0	0.0	202	32.0
1990	0	0.0	90	4.1	14	24.3	0	0.0	0	0.0	0	0.0	0	0.0	104	28.4
1991	0	0.0	95	10.6	16	23.8	0	0.0	0	0.0	0	0.0	0	0.0	111	34.3
1992	0	0.0	124	13.7	25	38.8	1	50.0	0	0.0	0	0.0	0	0.0	150	102.5
1993	0	0.0	34	3.7	2	2.5	2	40.0	0	0.0	0	0.0	0	0.0	38	46.2
1994	0	0.0	234	30.7	104	185.1	9	144.5	0	0.0	0	0.0	0	0.0	347	360.2
1995	0	0.0	43	6.1	8	13.8	0	0.0	0	0.0	0	0.0	0	0.0	51	19.9
1996	0	0.0	58	8.3	17	20.4	1	20.0	1	230.0	0	0.0	0	0.0	77	278.7
1997	0	0.0	33	3.7	7	14.1	2	51.0	0	0.0	0	0.0	0	0.0	42	68.8
1998	0	0.0	78	8.5	6	12.0	2	46.0	0	0.0	0	0.0	0	0.0	86	66.5
1999	0	0.0	61	8.1	11	20.7	0	0.0	0	0.0	0	0.0	0	0.0	72	28.9
2000	0	0.0	34	4.1	8	15.1	0	0.0	0	0.0	0	0.0	0	0.0	42	19.1
2001	0	0.0	57	7.8	13	17.8	0	0.0	0	0.0	0	0.0	0	0.0	70	25.6
2002	0	0.0	33	4.4	7	13.1	2	41.0	0	0.0	0	0.0	0	0.0	42	58.5
2003	0	0.0	28	3.7	5	7.2	1	31.7	0	0.0	0	0.0	0	0.0	34	42.6
2004	0	0.0	63	7.2	6	12.4	1	19.2	0	0.0	0	0.0	0	0.0	70	38.8
2005	0	0.0	14	2.0	4	21.0	1	26.0	0	0.0	0	0.0	0	0.0	19	49.0
2006	0	0.0	101	14.7	10	15.0	1	34.0	0	0.0	0	0.0	0	0.0	112	63.7
2007	0	0.0	32	4.6	16	38.9	3	76.5	0	0.0	0	0.0	0	0.0	51	120.0
2008	0	0.0	25	3.6	11	13.8	1	90.0	0	0.0	0	0.0	0	0.0	37	107.4
2009	0	0.0	34	3.7	6	5.0	0	0.0	0	0.0	0	0.0	0	0.0	40	8.7
2010	0	0.0	19	2.1	8	17.3	1	23.0	0	0.0	0	0.0	0	0.0	28	42.3
2011	0	0.0	30	4.5	12	17.3	0	0.0	0	0.0	0	0.0	0	0.0	42	21.8
2012	0	0.0	31	3.5	10	23.0	1	80.0	1	310.0	0	0.0	0	0.0	43	416.5
2013	0	0.0	49	6.9	16	23.5	2	102.3	1	110.0	0	0.0	1	1,100.0	69	1,342.7
2014	0	0.0	70	10.7	11	18.8	0	0.0	0	0.0	0	0.0	0	0.0	81	29.5
2015	0	0.0	38	6.6	11	8.0	1	40.0	0	0.0	1	689.0	1	1,750.0	52	2,493.6
2016	0	0.0	28	3.8	4	12.4	1	15.0	0	0.0	0	0.0	0	0.0	33	31.2
2017	0	0.0	17	2.8	4	15.0	0	0.0	0	0.0	0	0.0	0	0.0	21	17.8
2018	0	0.0	28	3.8	13	15.9	2	58.7	0	0.0	0	0.0	0	0.0	43	78.4
2019	0	0.0	31	3.8	5	11.2	2	50.6	0	0.0	0	0.0	0	0.0	38	65.6
	919	0	1,808	204.9	547	916.8	55	1,571.5	9	1,332.0	3	1,476.0	3	4,288.0	3,344	9,789.2

Size Class Code	Fires			Acres		
	Total	Average/Year	% of Total	Total	Average/Year	% of Total
(S) Spot	919	21.9	27.5%	0.0	0.0	0.0%
(A) .25 or less	1,808	43.0	54.1%	204.9	4.9	2.1%
(B) .26 through 9.9	547	13.0	16.4%	916.8	21.8	9.4%
(C) 10 through 99.9	55	1.3	1.6%	1,571.5	37.4	16.1%
(D) 100 through 299.9	9	0.2	0.3%	1,332.0	31.7	13.6%
(E) 300 through 999.9	3	0.1	0.1%	1,476.0	35.1	15.1%
(F) 1000 through 4999.9	3	0.1	0.1%	4,288.0	102.1	43.8%
<b>Total</b>	<b>3,344</b>	<b>79.6</b>	<b>100.0%</b>	<b>9,789.2</b>	<b>233.1</b>	<b>100%</b>

# 114 Year Fire Occurrence

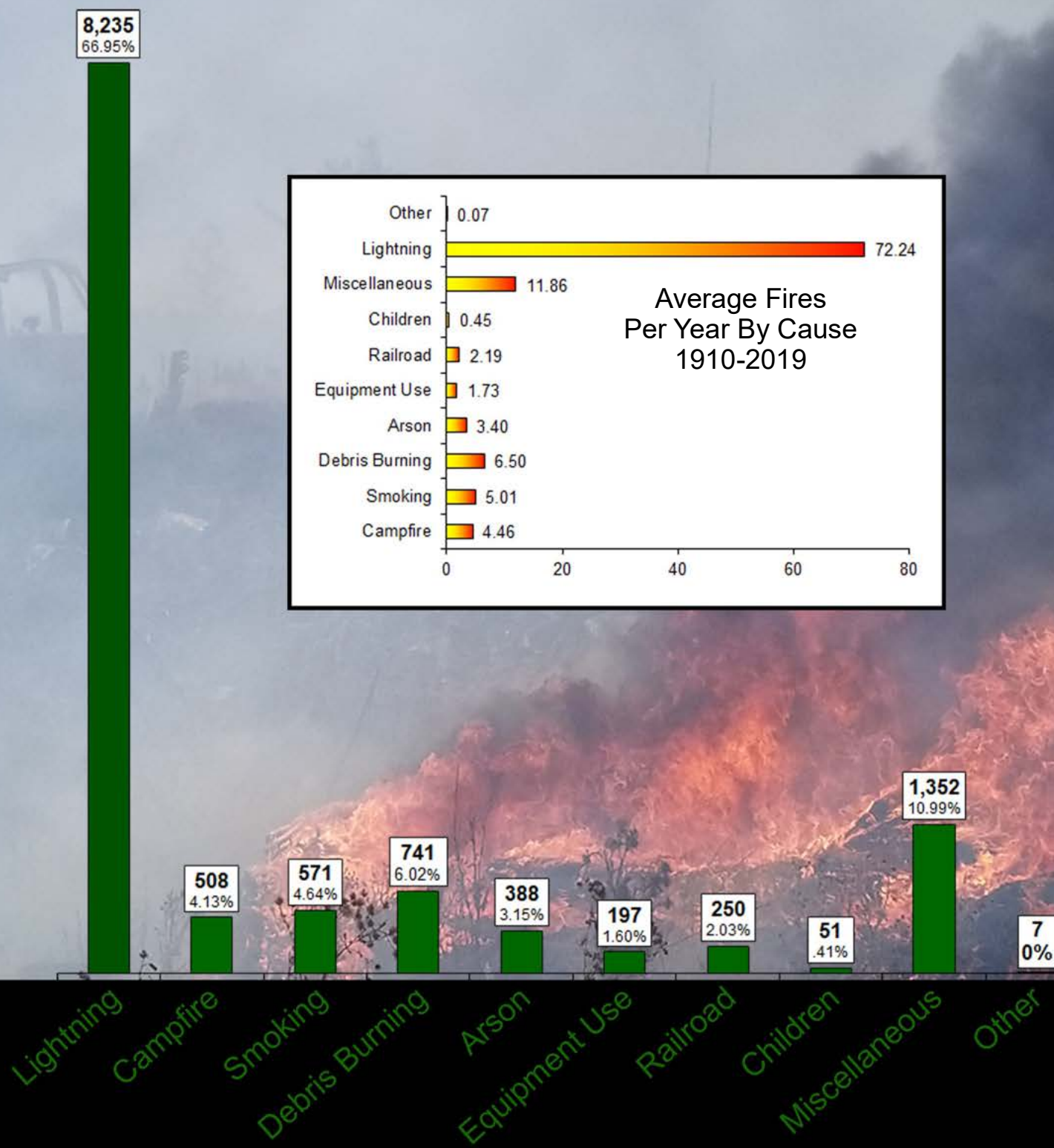



## Airplane Usage on Fires

Program	Cessna 185 (53083)	Super Cub (1679P)	Total
Protection	44	98.2	142.2
Corps Of Engineers	0	0	0
Maintenance	4.7	4.1	8.8
IDL Arson Investigation	0	0	0
Suppression	1.8	3.7	5.5
Total Hours	50.5	106	156.5
% of Total	32%	68%	100%

## Equipment Usage on Fires

Pump Use on Fires		
Type	# of Fires	% of Fires
Pressure Pump	4	11%
Filler Pump	4	11%
Slip Tank	0	0

Equipment Use on Fires		
Type	# of Fires	% of Fires
Type 2	4	11%
Type 4	7	18%
Type 5	3	8%
Type 6	20	53%
Type 7	6	16%
ATV	6	16%
UTV	6	13%
Dozer	5	13%
Excavator	2	5%
Transports	6	16%

# Detection Report 2019

To comply with federally mandated ADS-B requirements, a major upgrade was done to the Association owned Cessna 185 (N5083) in 2019. All analog components were replaced with digital components, allowing for better aircraft tracking and communication with other aircraft. A similar upgrade is slated for the other Association owned airplane, the Piper Super Cub (N1679P), in the spring of 2020.



Time Reported Until Arrival	
0 - 15 Minutes	2
15 - 30 Minutes	2
30-60 Minutes	4
1 - 1.5 Hours	3
1.5 - 3 Hours	4
3 - 5 Hours	6
8-12 Hours	3
12 - 24 Hours	3
24 Hours Plus	11
<b>Total</b>	<b>38</b>

Time Reported Until Fire Out	
0-1 Hours	1
1-2 Hours	2
1 - 2 Days	1
2 - 3 Days	1
3 - 5 Days	14
5 - 10 Days	10
10 Days Plus	9
<b>Total</b>	<b>38</b>

Fire Detections	Fires	Percent
Agency Aircraft	3	8%
Agency Lookout	1	3%
Agency Personnel	8	21%
Fire Department	1	3%
Non Agency Aircraft	1	3%
Person Starting Fire	1	3%
Public Report to 911	12	32%
Public Report to Agency	5	13%
Unknown, Other	6	16%
<b>Total</b>	<b>38</b>	<b>100%</b>



# Burn Permits 2019

---

Type of Burn Permit	Total
Burn Barrel (Residential Solid Waste Disposal)	107
Crop Residue, Pasture and CRP Burning	55
Residential Yard Waste/Orchard Clippings	164
Weed Control Along Ditch Banks and Fence Lines	4
Machine Piled Logging Slash	10
Hand Piled Logging Slash	61
2019 Total Burn Permits Issued	401

## Fire Occurrence Comparison

---

	Lightning	Human Caused
108 Year Average	76.16	37.42
2019 Fire Season	17	26

## Fuel Classifications

---

### 77 Day Statistical Fire Season July 1 - September 15

Fuel Model	Before	Statistical	After	Season Total
Fuel Model 1 - Short Grass	3	4	1	8
Fuel Model 2- Timber and Grass	2	7	1	10
Fuel Model 3 - Tall Grass	0	1	0	1
Fuel Model 4 - Chaparral	0	0	0	0
Fuel Model 5 - Brush	0	1	0	1
Fuel Model 6 - Dormant Brush/Hardwood Slash	0	0	0	0
Fuel Model 7 - Southern Rough	0	0	0	0
Fuel Model 8 - Closed Timber Litter	1	2	0	3
Fuel Model 9 - Hardwood/Long Leaf Pine Litter	0	0	1	1
Fuel Model 10 - Timber Litter and Understory	1	4	1	6
Fuel Model 11 - Light Logging Slash	3	2	0	5
Fuel Model 12 - Medium Logging Slash	0	3	0	3
Fuel Model 13 - Heavy Logging Slash	0	0	0	0
Grand Total	10	24	4	38

## Monthly Precipitation Comparison 2019

Taken at Elk River, Idaho

	May	June	July	August	September	October
Rainfall (Inches)	4.99	2.46	0.17	0.41	2.71	3.62
66 Year Average	2.38	2.16	0.85	1.00	1.57	3.71
Departure From Average	2.61	0.30	-0.68	-0.59	1.14	-0.09

Taken at Headquarters, Idaho

	May	June	July	August	September	October
Rainfall (Inches)	2.4	2.42	1.08	1.52	1.57	3.2
74 Year Average	2.71	2.66	1.21	1.31	1.77	2.66
Departure From Average	-0.31	-0.24	-0.13	0.21	-0.20	0.54

## Log Production 2019

Total log production from operators holding agreement under Surety Bond:	170,240,280 BF
Total log production from operators under Holdback Option 2:	9,515,950 BF
Total log production from operators under Option 1:	232,370 BF
<b>Total:</b>	<b>179,988,600 BF</b>

